

**MDKUBE25-365-KGT-OA-WN2-N** [↗](#)

Módulo lineal

Tandem actuators with four-row linear recirculating bearing and guideway assembly, monorail guidance system and ball screw drive. With second, non-driven carriage, without ball screw drive (no spindle), with fixing slots in carriage

Información técnica



Variante de su producto actual

Size code	25	
Length of carriage	365	365 mm
Drive type	OA	Without drive
Additional carriage	WN2	Second, non-driven carriage
Spindle support	/	None
Attachment to the carriage	N	T-Slots

Medidas principales y datos de rendimiento

L	365 mm	Length of Carriage
H	145 mm	Total Height
B 2	260 mm	Total Width

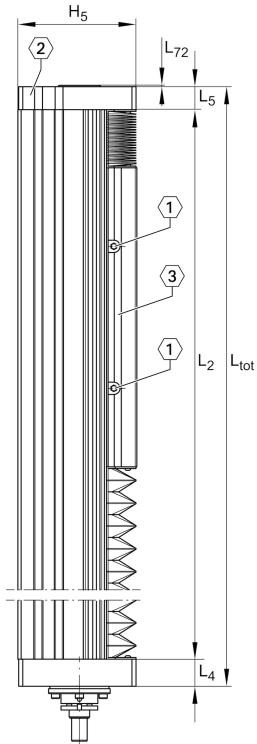

Medidas de montaje

B_1	250 mm	Width of Carriage
h_{13}	25 mm	
h_{14}	50 mm	
J_{B43}	35 mm	
J_{B44}	115 mm	
J_{B45}	185 mm	
j_{B8}	50 mm	
j_{B9}	110 mm	
j_{B10}	210 mm	
$L_2 \text{ max}$	5.850 mm	Maximum length of Support Rail
N_{B43}	14 mm	
N_{L43}	20 mm	

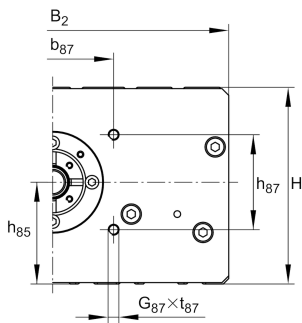
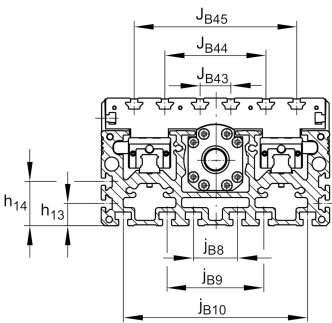



Medidas

B ₅	259 mm	Width of End Plates
F _{BL}	1,18	Effective length factor of bellow
H ₁	35 mm	Height of Carriage
H ₂	108 mm	Width of Support Rail
H ₅	144 mm	
L ₄	28 mm	
L ₅	28 mm	
L ₇₂	2 mm	
L _{x1 min}	20 mm	Minimum distance between the Carriages
S ₄₁	13 mm	



Datos técnicos

R_x	270 mm	
R_y	72,8 mm	
R_z	150 mm	
S	10 mm	Safety Distance
m_{LAW}	11,48 kg	Mass of Carriage
m_3	11,48 kg	Mass of additional Carriage
IC	47.200 N	Load direction I: compressive load
I C ₀	148.000 N	Load direction I: compressive load
II C	47.200 N	Load direction II: tensile load
II C ₀	148.000 N	Load direction II: tensile load
III C	47.200 N	Load direction III: lateral load
III C ₀	148.000 N	Load direction III: lateral load
$M_{0x \text{ per}}$	9.500 Nm	Max. permissible static moment per Carriage
$M_{0y \text{ per}}$	16.000 Nm	Max. permissible static moment per Carriage
$M_{0z \text{ per}}$	16.000 Nm	Max. permissible static moment per Carriage
I_y	7.069 cm ⁴	Geometrical moments of inertia of Support Rail
I_z	899 cm ⁴	Geometrical moments of inertia of Support Rail
WN2	Ja	Second, non-driven Carriage

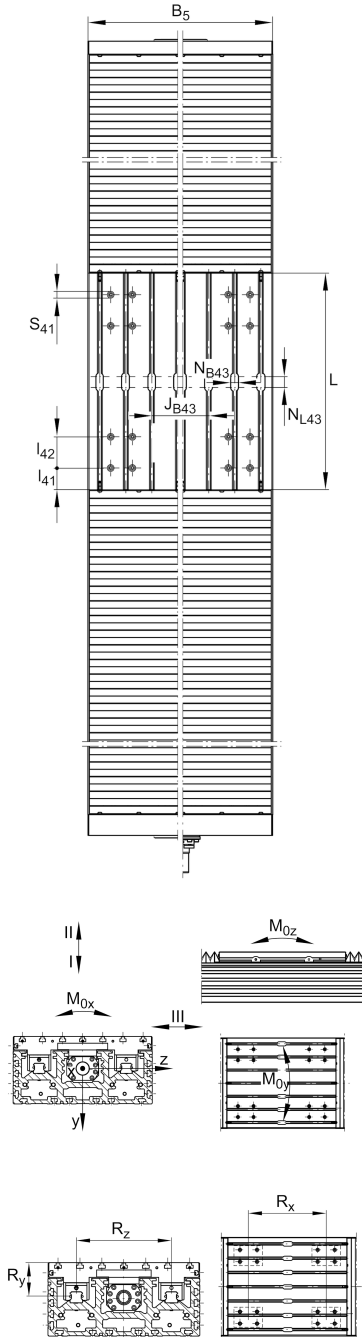



Información adicional

4x KWVE25-B-H

Carriage

