

**MDKUVE25-365-KGT/20-FM-SPU-N** [↗](#)

## Módulo lineal

Tandem actuators with four-row linear recirculating bearing and guideway assembly, monorail guidance system and ball screw drive. With single spindle support, double nut and fixing slots in carriage

## Información técnica

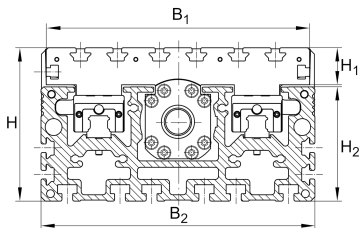

## Variante de su producto actual

|                            |     |                           |
|----------------------------|-----|---------------------------|
| Size code                  | 25  |                           |
| Length of carriage         | 365 | 365 mm                    |
| Drive type                 | KGT | Ball screw drive          |
| Spindle pitch              | 20  | 20 mm                     |
| Spindle nut design         | FM  | Flange nut & cylinder nut |
| Additional carriage        | /   | No additional carriage    |
| Spindle support            | SPU | Yes                       |
| Attachment to the carriage | N   | T-Slots                   |

## Medidas principales y datos de rendimiento

|     |        |                    |
|-----|--------|--------------------|
| L   | 365 mm | Length of Carriage |
| H   | 145 mm | Total Height       |
| B 2 | 260 mm | Total Width        |

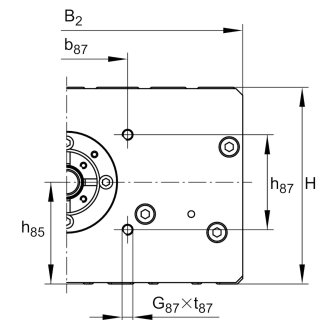
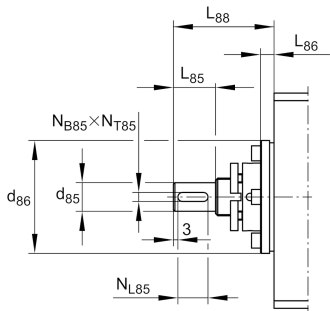
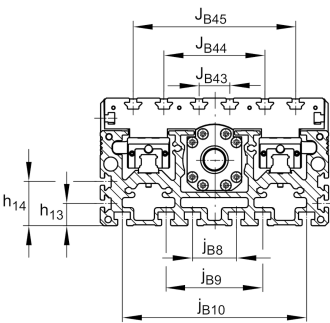
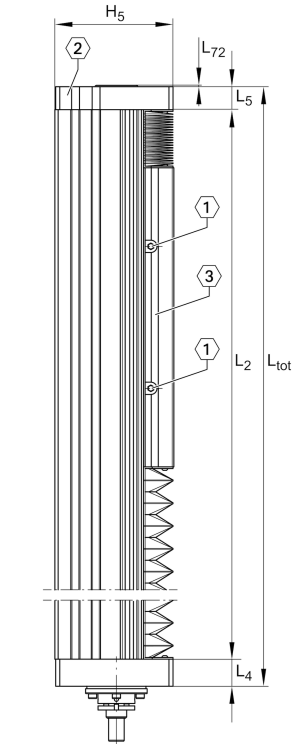

**Medidas de montaje**

|          |          |                                |
|----------|----------|--------------------------------|
| B 1      | 250 mm   | Width of Carriage              |
| b 87     | 90 mm    |                                |
| d 85     | 19 mm    |                                |
| Tol d 85 | h6       | Tolerance                      |
| d 86     | 75 mm    |                                |
| Tol d 86 | h7       | Tolerance                      |
| G 87     | M8       | Thread                         |
| h 13     | 25 mm    |                                |
| h 14     | 50 mm    |                                |
| h 85     | 75 mm    |                                |
| h 87     | 70 mm    |                                |
| J B43    | 35 mm    |                                |
| J B44    | 115 mm   |                                |
| J B45    | 185 mm   |                                |
| j B8     | 50 mm    |                                |
| j B9     | 110 mm   |                                |
| j B10    | 210 mm   |                                |
| L 2 max  | 5.850 mm | Maximum length of Support Rail |
| L 85     | 28 mm    |                                |
| L 86     | 9 mm     |                                |
| L 88     | 67 mm    |                                |
| N B43    | 14 mm    |                                |
| N B85    | 6 mm     | Tolerance P9                   |
| N L43    | 20 mm    |                                |
| N L85    | 20 mm    | Length of Keyway               |
| N T85    | 3,5 mm   | Depth of Keyway                |
| t 87     | 20 mm    | Depth of Thread                |



Medidas

|          |        |                                   |
|----------|--------|-----------------------------------|
| $B_5$    | 259 mm | Width of End Plates               |
| $F_{BL}$ | 1,18   | Effective length factor of bellow |
| $H_1$    | 35 mm  | Height of Carriage                |
| $H_2$    | 108 mm | Width of Support Rail             |
| $H_5$    | 144 mm |                                   |
| $L_4$    | 33 mm  |                                   |
| $L_5$    | 28 mm  |                                   |
| $L_{72}$ | 2 mm   |                                   |
| $I_{41}$ | 30 mm  |                                   |
| $I_{42}$ | 35 mm  |                                   |
| $S_{41}$ | 13 mm  |                                   |

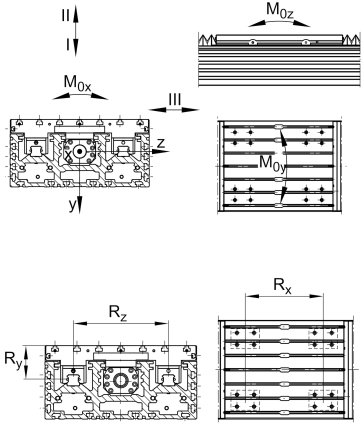



### Datos técnicos

|                     |                         |  |
|---------------------|-------------------------|--|
| R <sub>x</sub>      | 270 mm                  |  |
| R <sub>y</sub>      | 72,8 mm                 |  |
| R <sub>z</sub>      | 150 mm                  |  |
| S                   | 20 mm                   | Safety Distance                                |
| m <sub>LAW</sub>    | 13,04 kg                | Mass of Carriage                               |
| v <sub>max</sub>    | 0,43 m/s                | Maximum Speed                                  |
| a <sub>max</sub>    | 10 m/s <sup>2</sup>     | Maximum Acceleration                           |
| IC                  | 47.200 N                | Load direction I: compressive load             |
| I C <sub>0</sub>    | 148.000 N               | Load direction I: compressive load             |
| II C                | 47.200 N                | Load direction II: tensile load                |
| II C <sub>0</sub>   | 148.000 N               | Load direction II: tensile load                |
| III C               | 47.200 N                | Load direction III: lateral load               |
| III C <sub>0</sub>  | 148.000 N               | Load direction III: lateral load               |
| M <sub>0x per</sub> | 9.500 Nm                | Max. permissible static moment per Carriage    |
| M <sub>0y per</sub> | 16.000 Nm               | Max. permissible static moment per Carriage    |
| M <sub>0z per</sub> | 16.000 Nm               | Max. permissible static moment per Carriage    |
| I <sub>y</sub>      | 7.069 cm <sup>4</sup>   | Geometrical moments of inertia of Support Rail |
| I <sub>z</sub>      | 899 cm <sup>4</sup>     | Geometrical moments of inertia of Support Rail |
| C <sub>a MU</sub>   | 29.700 N                | Load capacity spindle nut dyn                  |
| C <sub>0a MU</sub>  | 59.800 N                | Load capacity spindle nut stat                 |
| C <sub>a L</sub>    | 27.500 N                | Load capacity fixed Spindle bearing dyn        |
| C <sub>0a L</sub>   | 55.000 N                | Load capacity fixed Spindle bearing stat       |
| d <sub>0</sub>      | 32 mm                   | Spindle Diameter                               |
| P                   | 20 mm                   | Spindle Pitch                                  |
| I <sub>s</sub>      | 6,43 kg*cm <sup>2</sup> | Mass moment of inertia of threaded Spindle     |
| SPU                 | Ja                      | Spindle Support                                |



Ver detalles del producto en Medias

11.11.2025, 19:37:26 UTC

**SCHAEFFLER**

### Información adicional

---

|                 |                  |
|-----------------|------------------|
| ZKLF2575-2RS-PE | Rolling Bearings |
|-----------------|------------------|

|    |              |
|----|--------------|
| FM | Drive System |
|----|--------------|

|               |          |
|---------------|----------|
| 4x KWVE25-B-H | Carriage |
|---------------|----------|