



LTE50-280-A-0 [↗](#)

Mesa lineal

Linear tables with closed shaft guidance system, without drive, with shaft support block type A, without bellows

Información técnica

Variante de su producto actual

| | | |
|--------------------|-----|---------------|
| Size code | 50 | |
| Length of carriage | 280 | 280 mm |
| Version | A | |
| Drive type | OA | Without drive |
| Bellow | 0 | No |

Medidas principales y datos de rendimiento

| | | |
|----------------|--------|--------------------|
| B ₁ | 280 mm | Total Width |
| H | 100 mm | Total Height |
| L | 280 mm | Length of Carriage |

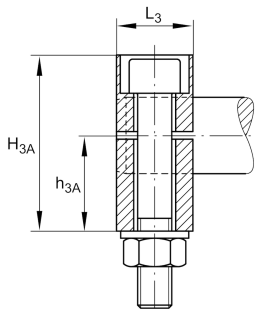
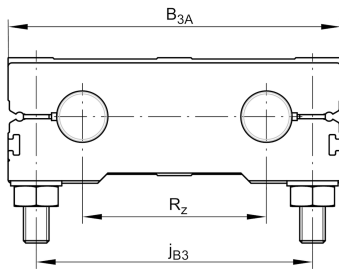

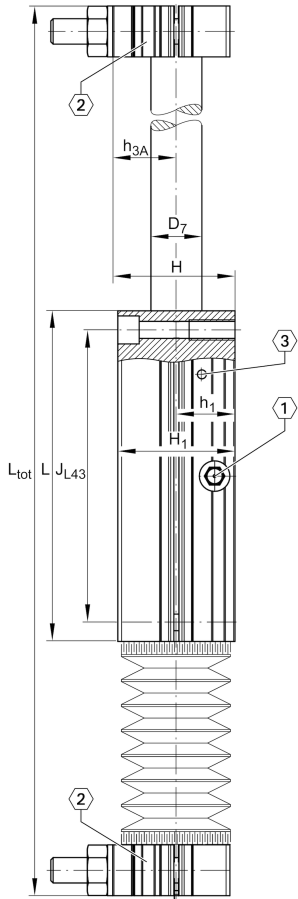

Medidas de montaje

| | | |
|------------------|---------|-------------------------------|
| B _{3A} | 280 mm | Width of Shaft Support Blocks |
| D ₃ | 17,5 mm | |
| G ₄₃ | M16 | Thread |
| J _{B43} | 250 mm | |
| J _{L43} | 250 mm | |
| j _{B3} | 240 mm | |
| j _{L3} | 15 mm | |
| K ₄₃ | M12 | Thread |
| S ₃ | 26 mm | |
| T ₃ | 21 mm | |
| t ₄₃ | 34 mm | Depth of Thread |

Medidas

| | | |
|-----------------|-------|--------------------------------|
| H ₁ | 96 mm | Height of Carriage |
| H _{3A} | 96 mm | Height of Shaft Support Blocks |
| h ₁ | 48 mm | |
| h _{3A} | 52 mm | |
| L ₃ | 30 mm | Length of Shaft Support Blocks |
| D ₇ | 50 mm | Ø Shaft, Tolerance h7 |

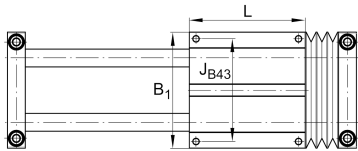

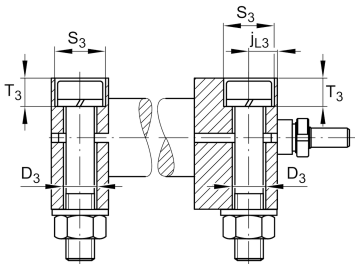
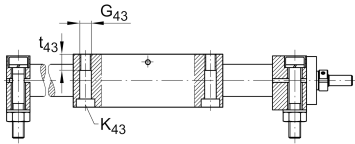
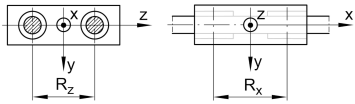
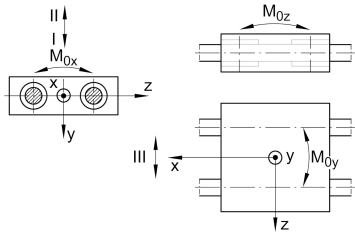

Datos técnicos

| | | |
|---------------------|---------------------|---|
| R _x | 163 mm | |
| R _z | 152 mm | |
| S | 0 mm | Safety Distance |
| m _{LAW} | 16,4 kg | Mass of Carriage |
| v _{max} | 5 m/s | Maximum Speed |
| a _{max} | 50 m/s ² | Maximum Acceleration |
| C _I | 22.950 N | Load direction I: compressive load |
| C _{0I} | 25.200 N | Load direction I: compressive load |
| C _{II} | 22.950 N | Load direction II: tensile load |
| C _{0II} | 25.200 N | Load direction II: tensile load |
| C _{III} | 22.950 N | Load direction III: lateral load |
| C _{0III} | 25.200 N | Load direction III: lateral load |
| M _{0x per} | 1.904 Nm | Max. permissible static moment per Carriage |
| M _{0y per} | 1.736 Nm | Max. permissible static moment per Carriage |
| M _{0z per} | 1.510 Nm | Max. permissible static moment per Carriage |

Información adicional

KB50-P

Linear Ball Bearings

Rango de temperatura

0 °C

Minimum operating Temperatur

80 °C

Maximum operating Temperatur