

**LTE40-230-A-1** [↗](#)

Mesa lineal

Linear tables with closed shaft guidance system, without drive, with shaft support block type A, with bellows

Información técnica

Variante de su producto actual

Size code	40	indicación de tamaño
Length of carriage	230	230 mm
Version	A	
Drive type	OA	Without drive
Bellow	1	Yes

Medidas principales y datos de rendimiento

B ₁	230 mm	Total Width
H	84 mm	Total Height
L	230 mm	Length of Carriage

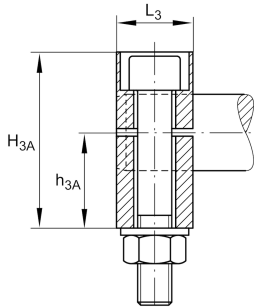
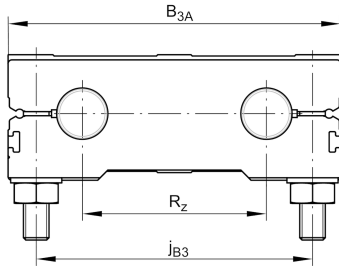

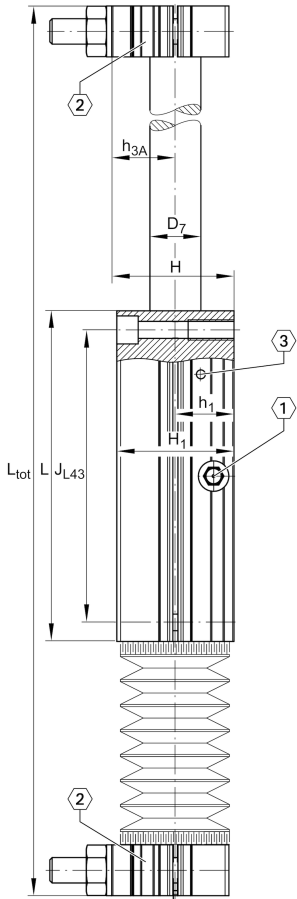

Medidas de montaje

B _{3A}	230 mm	Width of Shaft Support Blocks
D ₃	17,5 mm	
G ₄₃	M16	Thread
J _{B43}	202 mm	
J _{L43}	202 mm	
j _{B3}	190 mm	
j _{L3}	15 mm	
K ₄₃	M12	Thread
S ₃	26 mm	
T ₃	14,5 mm	
t ₄₃	34 mm	Depth of Thread

Medidas

B _B	22 mm	Length of Bellows Fastener
F _{BL}	1,28	Effective length factor of bellow
H ₁	80 mm	Height of Carriage
H _{3A}	80 mm	Height of Shaft Support Blocks
h ₁	40 mm	
h _{3A}	44 mm	
L ₃	30 mm	Length of Shaft Support Blocks
D ₇	40 mm	Ø Shaft, Tolerance h7

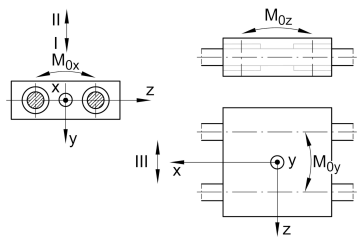
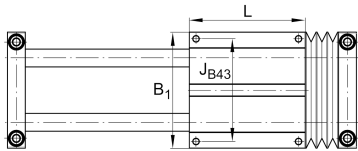

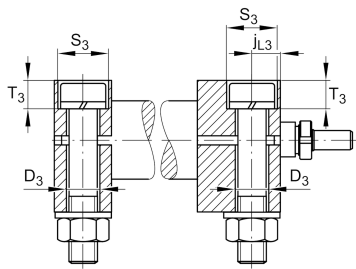
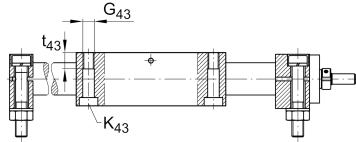
**Datos técnicos**

R _x	134 mm	
R _z	122 mm	
S	0 mm	Safety Distance
m _{LAW}	10,3 kg	Mass of Carriage
v _{max}	5 m/s	Maximum Speed
a _{max}	50 m/s ²	Maximum Acceleration
C _I	15.830 N	Load direction I: compressive load
C _{0I}	17.600 N	Load direction I: compressive load
C _{II}	15.830 N	Load direction II: tensile load
C _{0II}	17.600 N	Load direction II: tensile load
C _{III}	15.830 N	Load direction III: lateral load
C _{0III}	17.600 N	Load direction III: lateral load
M _{0x per}	1.080 Nm	Max. permissible static moment per Carriage
M _{0y per}	970 Nm	Max. permissible static moment per Carriage
M _{0z per}	876 Nm	Max. permissible static moment per Carriage

Información adicional

KB40-P	Linear Ball Bearings
--------	----------------------

Rango de temperatura

0 °C	Minimum operating Temperatur
80 °C	Maximum operating Temperatur