

**LTE40-230-A-0** **Mesa lineal**

Linear tables with closed shaft guidance system, without drive, with shaft support block type A, without bellows

Información técnica**Variante de su producto actual**

Size code	40	indicación de tamaño
Length of carriage	230	230 mm
Version	A	
Drive type	OA	Without drive
Bellow	0	No

Medidas principales y datos de rendimiento

B ₁	230 mm	Total Width
H	84 mm	Total Height
L	230 mm	Length of Carriage

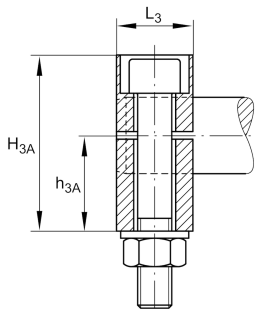
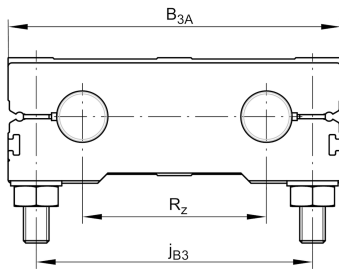

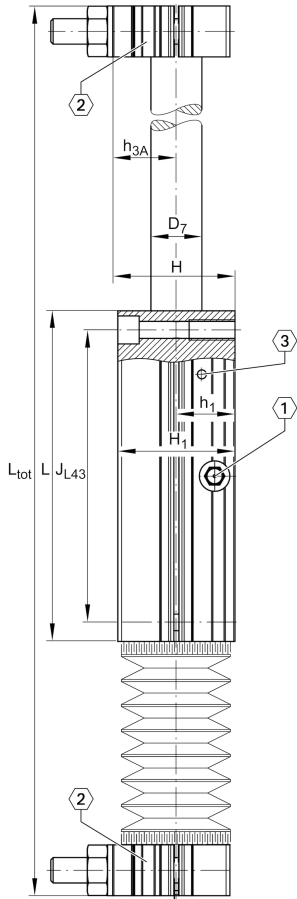

Medidas de montaje

B _{3A}	230 mm	Width of Shaft Support Blocks
D ₃	17,5 mm	
G ₄₃	M16	Thread
J _{B43}	202 mm	
J _{L43}	202 mm	
j _{B3}	190 mm	
j _{L3}	15 mm	
K ₄₃	M12	Thread
S ₃	26 mm	
T ₃	14,5 mm	
t ₄₃	34 mm	Depth of Thread

Medidas

H ₁	80 mm	Height of Carriage
H _{3A}	80 mm	Height of Shaft Support Blocks
h ₁	40 mm	
h _{3A}	44 mm	
L ₃	30 mm	Length of Shaft Support Blocks
D ₇	40 mm	Ø Shaft, Tolerance h7

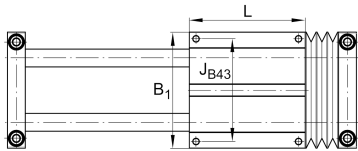

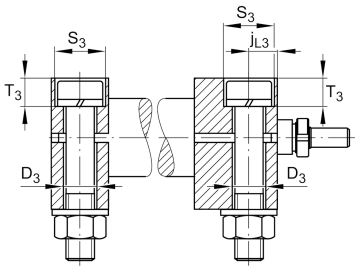
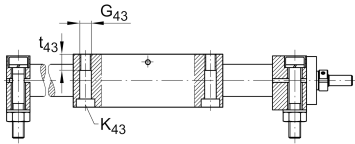
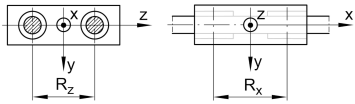
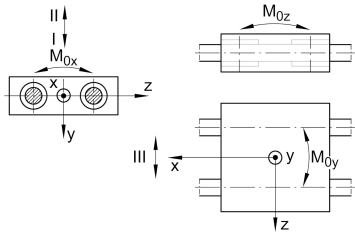

Datos técnicos

R _x	134 mm	
R _z	122 mm	
S	0 mm	Safety Distance
m _{LAW}	10,3 kg	Mass of Carriage
v _{max}	5 m/s	Maximum Speed
a _{max}	50 m/s ²	Maximum Acceleration
C _I	15.830 N	Load direction I: compressive load
C _{0I}	17.600 N	Load direction I: compressive load
C _{II}	15.830 N	Load direction II: tensile load
C _{0II}	17.600 N	Load direction II: tensile load
C _{III}	15.830 N	Load direction III: lateral load
C _{0III}	17.600 N	Load direction III: lateral load
M _{0x per}	1.080 Nm	Max. permissible static moment per Carriage
M _{0y per}	970 Nm	Max. permissible static moment per Carriage
M _{0z per}	876 Nm	Max. permissible static moment per Carriage

Información adicional

KB40-P

Linear Ball Bearings

Rango de temperatura

0 °C

Minimum operating Temperatur

80 °C

Maximum operating Temperatur