



### LTE30-180-A-0 [↗](#)

#### Mesa lineal

Linear tables with closed shaft guidance system, without drive, with shaft support block type A, without bellows

## Información técnica

### Variante de su producto actual

Size code	30	
Length of carriage	180	180 mm
Version	A	
Drive type	OA	Without drive
Bellow	0	No

### Medidas principales y datos de rendimiento

B <sub>1</sub>	180 mm	Total Width
H	67 mm	Total Height
L	180 mm	Length of Carriage

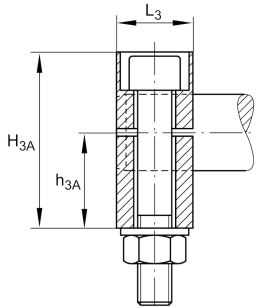
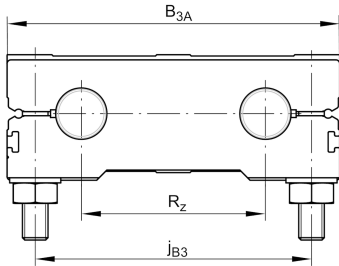

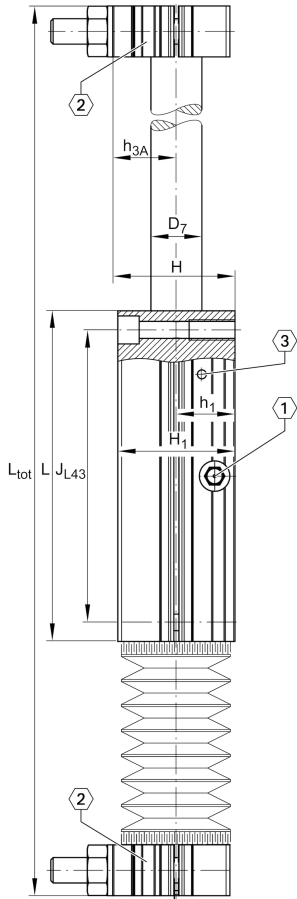

### Medidas de montaje

B <sub>3A</sub>	180 mm	Width of Shaft Support Blocks
D <sub>3</sub>	13,5 mm	
G <sub>43</sub>	M12	Thread
J <sub>B43</sub>	158 mm	
J <sub>L43</sub>	158 mm	
j <sub>B3</sub>	150 mm	
j <sub>L3</sub>	12,5 mm	
K <sub>43</sub>	M10	Thread
S <sub>3</sub>	20 mm	
T <sub>3</sub>	15,5 mm	
t <sub>43</sub>	26 mm	Depth of Thread

### Medidas

H <sub>1</sub>	64 mm	Height of Carriage
H <sub>3A</sub>	64 mm	Height of Shaft Support Blocks
h <sub>1</sub>	32 mm	
h <sub>3A</sub>	35 mm	
L <sub>3</sub>	25 mm	Length of Shaft Support Blocks
D <sub>7</sub>	30 mm	Ø Shaft, Tolerance h7

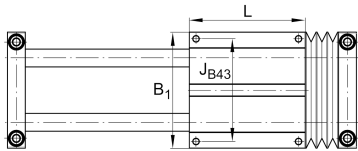

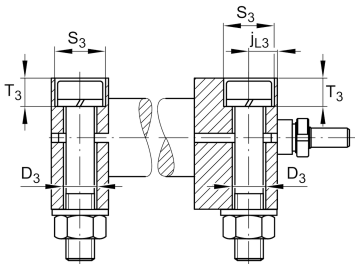
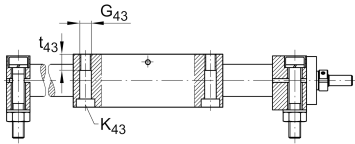
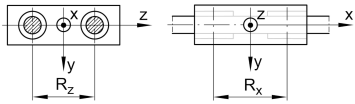
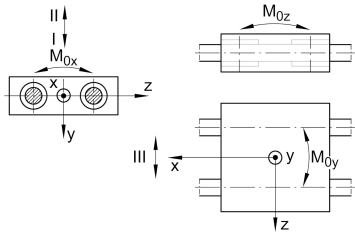

### Datos técnicos

R X	98,6 mm	
R Z	96 mm	
S	0 mm	Safety Distance
m LAW	5,1 kg	Mass of Carriage
v max	5 m/s	Maximum Speed
a max	50 m/s <sup>2</sup>	Maximum Acceleration
C I	9.500 N	Load direction I: compressive load
C 0I	11.400 N	Load direction I: compressive load
C II	9.500 N	Load direction II: tensile load
C 0II	11.400 N	Load direction II: tensile load
C III	9.500 N	Load direction III: lateral load
C 0III	11.400 N	Load direction III: lateral load
M 0x per	540 Nm	Max. permissible static moment per Carriage
M 0y per	503 Nm	Max. permissible static moment per Carriage
M 0z per	393 Nm	Max. permissible static moment per Carriage

### Información adicional

KB30-P

Linear Ball Bearings

### Rango de temperatura

0 °C

Minimum operating Temperatur

80 °C

Maximum operating Temperatur