



### LTE25-160-A-0 [↗](#)

#### Mesa lineal

Linear tables with closed shaft guidance system, without drive, with shaft support block type A, without bellows

## Información técnica

### Variante de su producto actual

Size code	25	
Length of carriage	160	160 mm
Version	A	
Drive type	OA	Without drive
Bellow	0	No

### Medidas principales y datos de rendimiento

B <sub>1</sub>	160 mm	Total Width
H	58 mm	Total Height
L	160 mm	Length of Carriage

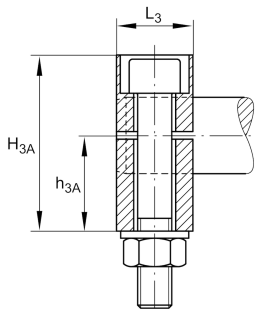
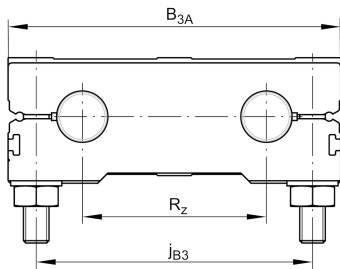

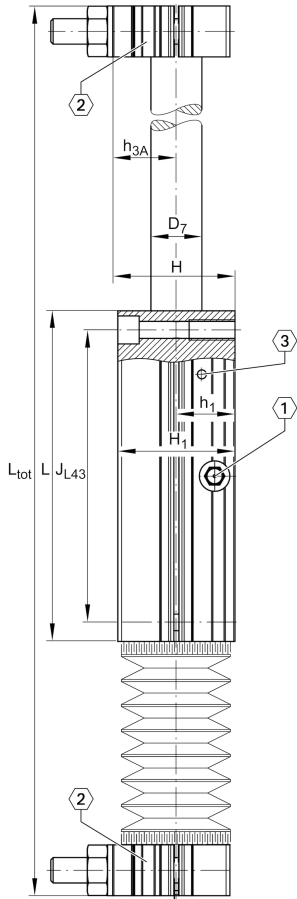

### Medidas de montaje

B <sub>3A</sub>	160 mm	Width of Shaft Support Blocks
D <sub>3</sub>	13,5 mm	
G <sub>43</sub>	M10	Thread
J <sub>B43</sub>	140 mm	
J <sub>L43</sub>	140 mm	
j <sub>B3</sub>	132 mm	
j <sub>L3</sub>	12,5 mm	
K <sub>43</sub>	M8	Thread
S <sub>3</sub>	20 mm	
T <sub>3</sub>	15,5 mm	
t <sub>43</sub>	22 mm	Depth of Thread

### Medidas

H <sub>1</sub>	56 mm	Height of Carriage
H <sub>3A</sub>	56 mm	Height of Shaft Support Blocks
h <sub>1</sub>	28 mm	
h <sub>3A</sub>	30 mm	
L <sub>3</sub>	25 mm	Length of Shaft Support Blocks
D <sub>7</sub>	25 mm	Ø Shaft, Tolerance h7

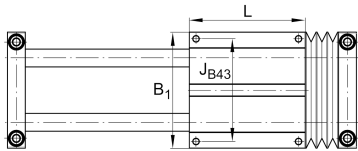

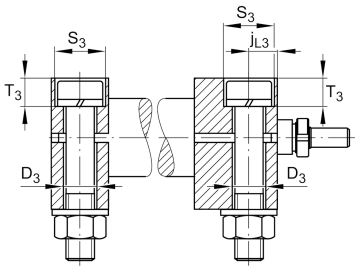
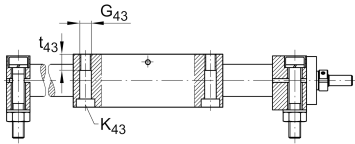
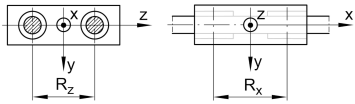
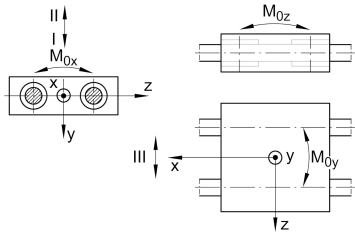

### Datos técnicos

R <sub>x</sub>	88,6 mm	
R <sub>z</sub>	88 mm	
S	0 mm	Safety Distance
m <sub>LAW</sub>	3,5 kg	Mass of Carriage
v <sub>max</sub>	5 m/s	Maximum Speed
a <sub>max</sub>	50 m/s <sup>2</sup>	Maximum Acceleration
C <sub>I</sub>	7.390 N	Load direction I: compressive load
C <sub>0I</sub>	8.880 N	Load direction I: compressive load
C <sub>II</sub>	7.390 N	Load direction II: tensile load
C <sub>0II</sub>	8.880 N	Load direction II: tensile load
C <sub>III</sub>	7.390 N	Load direction III: lateral load
C <sub>0III</sub>	8.880 N	Load direction III: lateral load
M <sub>0x per</sub>	390 Nm	Max. permissible static moment per Carriage
M <sub>0y per</sub>	340 Nm	Max. permissible static moment per Carriage
M <sub>0z per</sub>	280 Nm	Max. permissible static moment per Carriage

### Información adicional

KB25-P

Linear Ball Bearings

### Rango de temperatura

0 °C

Minimum operating Temperatur

80 °C

Maximum operating Temperatur