

**LTE20-130-A-OA-1** [↗](#)

## Mesa lineal

Linear tables with closed shaft guidance system, without drive, with shaft support block type A, with bellows

## Información técnica

## Variante de su producto actual

|                    |     |               |
|--------------------|-----|---------------|
| Size code          | 20  |               |
| Length of carriage | 130 | 130 mm        |
| Version            | A   |               |
| Drive type         | OA  | Without drive |
| Bellow             | 1   | Yes           |

## Medidas principales y datos de rendimiento

|                |        |                    |
|----------------|--------|--------------------|
| B <sub>1</sub> | 130 mm | Total Width        |
| H              | 48 mm  | Total Height       |
| L              | 130 mm | Length of Carriage |

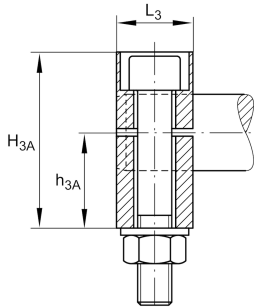
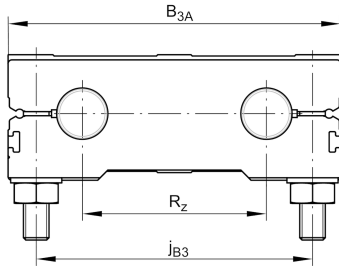

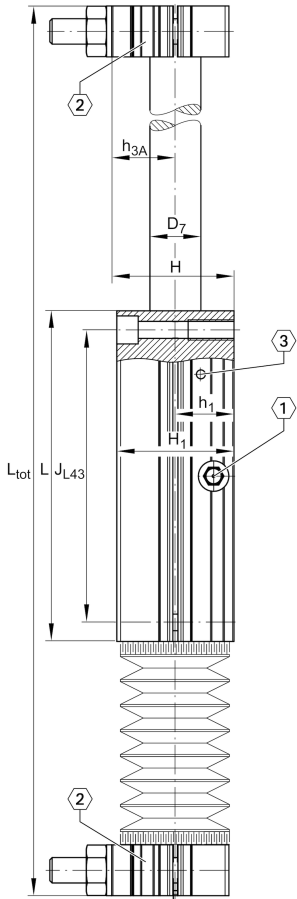

**Medidas de montaje**

|                  |        |                               |
|------------------|--------|-------------------------------|
| B <sub>3A</sub>  | 130 mm | Width of Shaft Support Blocks |
| D <sub>3</sub>   | 11 mm  |                               |
| G <sub>43</sub>  | M8     | Thread                        |
| J <sub>B43</sub> | 115 mm |                               |
| J <sub>L43</sub> | 115 mm |                               |
| j <sub>B3</sub>  | 108 mm |                               |
| j <sub>L3</sub>  | 10 mm  |                               |
| K <sub>43</sub>  | M6     | Thread                        |
| S <sub>3</sub>   | 18 mm  |                               |
| T <sub>3</sub>   | 10 mm  |                               |
| t <sub>43</sub>  | 18 mm  | Depth of Thread               |

**Medidas**

|                 |       |                                   |
|-----------------|-------|-----------------------------------|
| B <sub>B</sub>  | 20 mm | Length of Bellows Fastener        |
| F <sub>BL</sub> | 1,33  | Effective length factor of bellow |
| H <sub>1</sub>  | 46 mm | Height of Carriage                |
| H <sub>3A</sub> | 46 mm | Height of Shaft Support Blocks    |
| h <sub>1</sub>  | 23 mm |                                   |
| h <sub>3A</sub> | 25 mm |                                   |
| L <sub>3</sub>  | 20 mm | Length of Shaft Support Blocks    |
| D <sub>7</sub>  | 20 mm | Ø Shaft, Tolerance h7             |

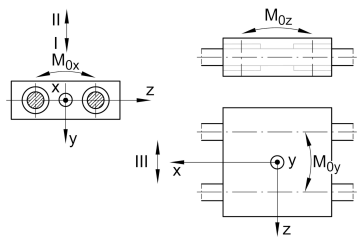
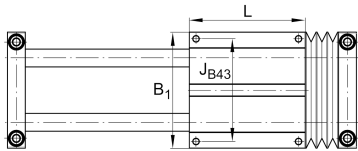



### Datos técnicos

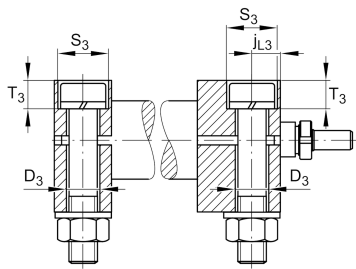
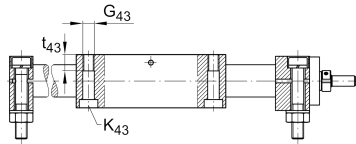

|          |                     |   |
|----------|---------------------|---|
| R X      | 74,6 mm             |   |
| R Z      | 72 mm               |   |
| S        | 0 mm                | Safety Distance                             |
| m LAW    | 1,8 kg              | Mass of Carriage                            |
| v max    | 5 m/s               | Maximum Speed                               |
| a max    | 50 m/s <sup>2</sup> | Maximum Acceleration                        |
| C I      | 4.140 N             | Load direction I: compressive load          |
| C 0I     | 4.920 N             | Load direction I: compressive load          |
| C II     | 4.140 N             | Load direction II: tensile load             |
| C 0II    | 4.920 N             | Load direction II: tensile load             |
| C III    | 4.140 N             | Load direction III: lateral load            |
| C 0III   | 4.920 N             | Load direction III: lateral load            |
| M 0x per | 178 Nm              | Max. permissible static moment per Carriage |
| M 0y per | 155 Nm              | Max. permissible static moment per Carriage |
| M 0z per | 138 Nm              | Max. permissible static moment per Carriage |

### Información adicional

KB20-P

Linear Ball Bearings

### Rango de temperatura

0 °C

Minimum operating Temperatur

80 °C

Maximum operating Temperatur