



LTE20-130-A-OA-0 [↗](#)

Mesa lineal

Linear tables with closed shaft guidance system, without drive, with shaft support block type A, without bellows

Información técnica

Variante de su producto actual

Size code	20	
Length of carriage	130	130 mm
Version	A	
Drive type	OA	Without drive
Bellow	0	No

Medidas principales y datos de rendimiento

B ₁	130 mm	Total Width
H	48 mm	Total Height
L	130 mm	Length of Carriage

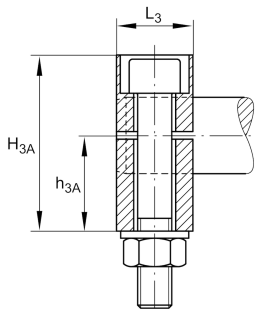
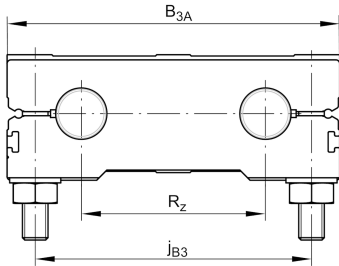

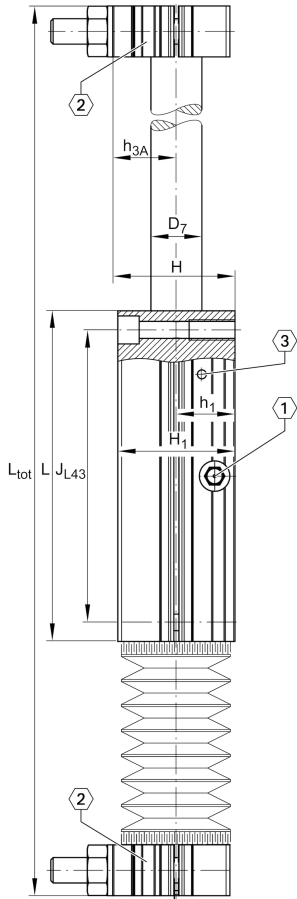

Medidas de montaje

B _{3A}	130 mm	Width of Shaft Support Blocks
D ₃	11 mm	
G ₄₃	M8	Thread
J _{B43}	115 mm	
J _{L43}	115 mm	
j _{B3}	108 mm	
j _{L3}	10 mm	
K ₄₃	M6	Thread
S ₃	18 mm	
T ₃	10 mm	
t ₄₃	18 mm	Depth of Thread

Medidas

H ₁	46 mm	Height of Carriage
H _{3A}	46 mm	Height of Shaft Support Blocks
h ₁	23 mm	
h _{3A}	25 mm	
L ₃	20 mm	Length of Shaft Support Blocks
D ₇	20 mm	Ø Shaft, Tolerance h7

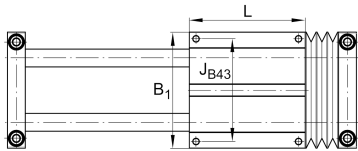

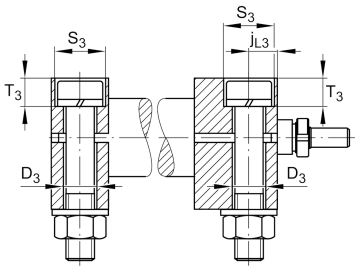
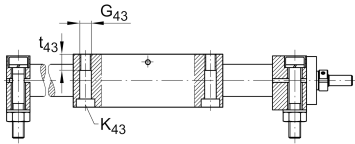
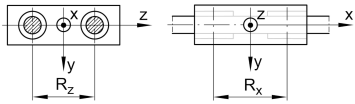
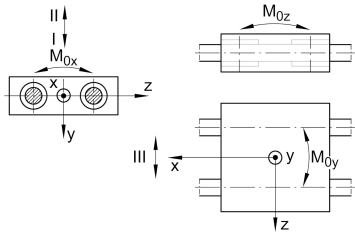

Datos técnicos

R X	74,6 mm	
R Z	72 mm	
S	0 mm	Safety Distance
m LAW	1,8 kg	Mass of Carriage
v max	5 m/s	Maximum Speed
a max	50 m/s ²	Maximum Acceleration
C I	4.140 N	Load direction I: compressive load
C 0I	4.920 N	Load direction I: compressive load
C II	4.140 N	Load direction II: tensile load
C 0II	4.920 N	Load direction II: tensile load
C III	4.140 N	Load direction III: lateral load
C 0III	4.920 N	Load direction III: lateral load
M 0x per	178 Nm	Max. permissible static moment per Carriage
M 0y per	155 Nm	Max. permissible static moment per Carriage
M 0z per	138 Nm	Max. permissible static moment per Carriage

Información adicional

KB20-P	Linear Ball Bearings
--------	----------------------

Rango de temperatura

0 °C	Minimum operating Temperatur
------	------------------------------

80 °C	Maximum operating Temperatur
-------	------------------------------