

**LTE16-100-A-1** [↗](#)

Mesa lineal

Linear tables with closed shaft guidance system, without drive, with shaft support block type A, with bellows

Información técnica

Variante de su producto actual

Size code	16	indicación de tamaño
Length of carriage	100	100 mm
Version	A	
Drive type	OA	Without drive
Bellow	1	Yes

Medidas principales y datos de rendimiento

B ₁	100 mm	Total Width
H	38 mm	Total Height
L	100 mm	Length of Carriage

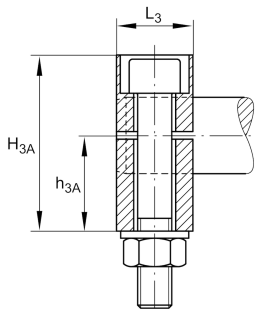
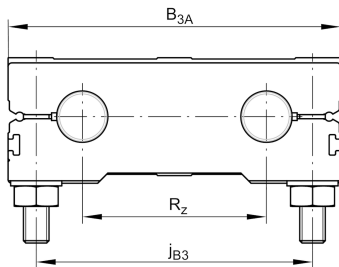

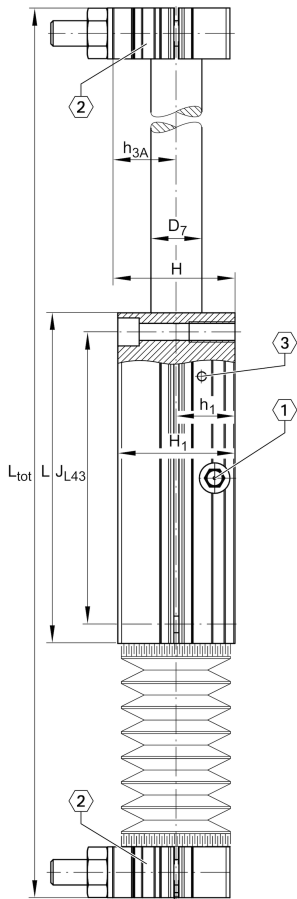

Medidas de montaje

B _{3A}	100 mm	Width of Shaft Support Blocks
D ₃	9 mm	
G ₄₃	M6	Thread
J _{B43}	88 mm	
J _{L43}	88 mm	
j _{B3}	82 mm	
j _{L3}	9 mm	
K ₄₃	M5	Thread
S ₃	15 mm	
T ₃	8 mm	
t ₄₃	13 mm	Depth of Thread

Medidas

B _B	20 mm	Length of Bellows Fastener
F _{BL}	1,5	Effective length factor of bellow
H ₁	36 mm	Height of Carriage
H _{3A}	36 mm	Height of Shaft Support Blocks
h ₁	18 mm	
h _{3A}	20 mm	
L ₃	18 mm	Length of Shaft Support Blocks
D ₇	16 mm	Ø Shaft, Tolerance h7

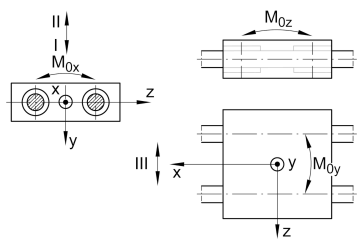
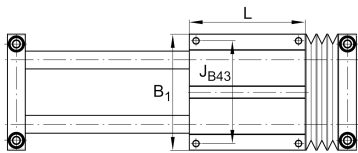



Datos técnicos

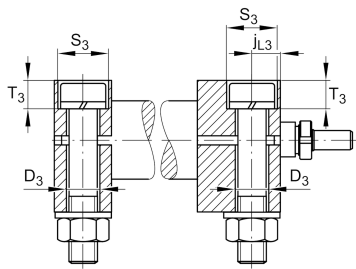
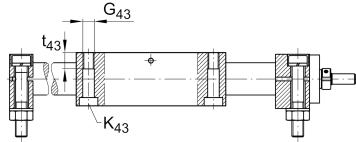

R X	55,6 mm	
R Z	54 mm	
S	0 mm	Safety Distance
m LAW	0,9 kg	Mass of Carriage
v max	5 m/s	Maximum Speed
a max	50 m/s ²	Maximum Acceleration
C I	1.870 N	Load direction I: compressive load
C 0I	2.120 N	Load direction I: compressive load
C II	1.870 N	Load direction II: tensile load
C 0II	2.120 N	Load direction II: tensile load
C III	1.870 N	Load direction III: lateral load
C 0III	2.120 N	Load direction III: lateral load
M 0x per	57 Nm	Max. permissible static moment per Carriage
M 0y per	48 Nm	Max. permissible static moment per Carriage
M 0z per	45 Nm	Max. permissible static moment per Carriage

Información adicional

KB16-P

Linear Ball Bearings

Rango de temperatura

0 °C

Minimum operating Temperatur

80 °C

Maximum operating Temperatur