

**LTE16-100-A-0** [↗](#)**Mesa lineal**

Linear tables with closed shaft guidance system, without drive, with shaft support block type A, without bellows

**Información técnica****Variante de su producto actual**

Size code	16	indicación de tamaño
Length of carriage	100	100 mm
Version	A	
Drive type	OA	Without drive
Bellow	0	No

**Medidas principales y datos de rendimiento**

B <sub>1</sub>	100 mm	Total Width
H	38 mm	Total Height
L	100 mm	Length of Carriage

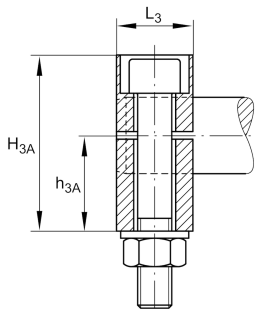
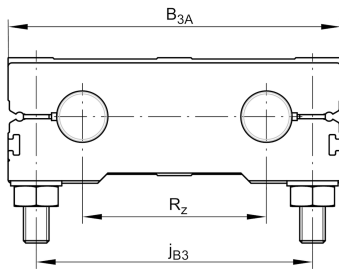

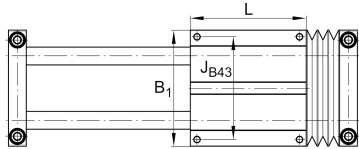
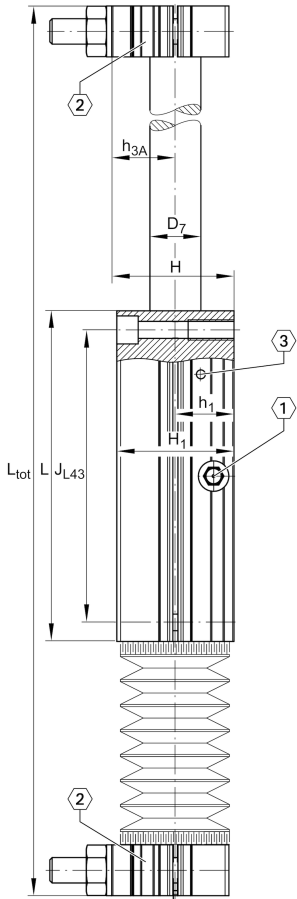

### Medidas de montaje

B <sub>3A</sub>	100 mm	Width of Shaft Support Blocks
D <sub>3</sub>	9 mm	
G <sub>43</sub>	M6	Thread
J <sub>B43</sub>	88 mm	
J <sub>L43</sub>	88 mm	
j <sub>B3</sub>	82 mm	
j <sub>L3</sub>	9 mm	
K <sub>43</sub>	M5	Thread
S <sub>3</sub>	15 mm	
T <sub>3</sub>	8 mm	
t <sub>43</sub>	13 mm	Depth of Thread

### Medidas

H <sub>1</sub>	36 mm	Height of Carriage
H <sub>3A</sub>	36 mm	Height of Shaft Support Blocks
h <sub>1</sub>	18 mm	
h <sub>3A</sub>	20 mm	
L <sub>3</sub>	18 mm	Length of Shaft Support Blocks
D <sub>7</sub>	16 mm	Ø Shaft, Tolerance h7

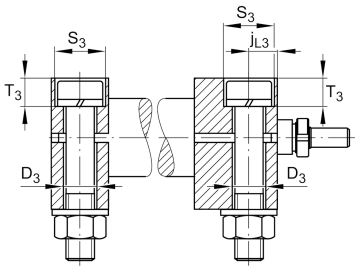
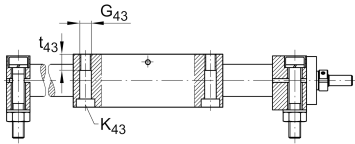
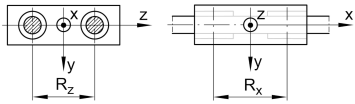
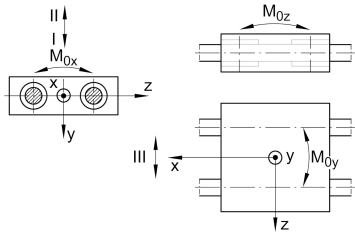

### Datos técnicos

R X	55,6 mm	
R Z	54 mm	
S	0 mm	Safety Distance
m LAW	0,9 kg	Mass of Carriage
v max	5 m/s	Maximum Speed
a max	50 m/s <sup>2</sup>	Maximum Acceleration
C I	1.870 N	Load direction I: compressive load
C 0I	2.120 N	Load direction I: compressive load
C II	1.870 N	Load direction II: tensile load
C 0II	2.120 N	Load direction II: tensile load
C III	1.870 N	Load direction III: lateral load
C 0III	2.120 N	Load direction III: lateral load
M 0x per	57 Nm	Max. permissible static moment per Carriage
M 0y per	48 Nm	Max. permissible static moment per Carriage
M 0z per	45 Nm	Max. permissible static moment per Carriage

### Información adicional

KB16-P

Linear Ball Bearings

### Rango de temperatura

0 °C

Minimum operating Temperatur

80 °C

Maximum operating Temperatur