**KGSNS40-PP-AS**

Unidad de rodamiento lineal de bolas

Linear ball bearing and housing unit; with self-aligning linear ball bearing, slotted design, sealed, greased, with relubrication facility

Información técnica

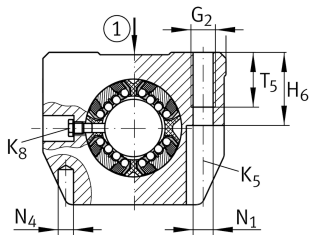
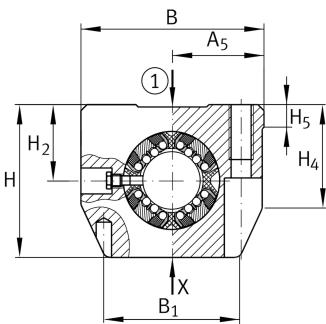

Variante de su producto actual

Size code	40	indicación de tamaño
Seal	PP	
n.r.		
	AS	Relubrication facility
≈m	1,65 kg	Peso

Medidas principales y datos de rendimiento

F _w	40 mm	Diameter of ball complement
H	90 mm	Height
L	80 mm	Longitud
B	108 mm	Anchura
C _{max}	10.200 N	Load capacity dyn.
C _{0 max}	9.600 N	Load capacity stat.



Medidas de montaje

J _B	86 mm	
B ₁	76 mm	
A ₅	54 mm	
Tol A ₅	+ 0,01 mm	Upper tolerance
Tol A ₅	- 0,01 mm	Lower tolerance
J _L	58 mm	Distance
Tol J _L	+ 0,15 mm	Upper tolerance
H ₂	45 mm	Center height
H ₄	57,6 mm	
H ₅	11,7 mm	
T ₅	26 mm	Mounting Dimension
H ₆	44 mm	Mounting Dimension
G ₂	M12	
N ₁	10,5 mm	Mounting Dimension
N ₄	8 mm	
N ₃	18 mm	Mounting Dimension
K ₅	M10	
K ₈	NIP5MZ	Lubrication nipple
W	6 mm	Width across flats
	8	Ball rows

