**KGSNS12-PP-AS**

## Unidad de rodamiento lineal de bolas

Linear ball bearing and housing unit; with self-aligning linear ball bearing, slotted design, sealed, greased, with relubrication facility

## Información técnica

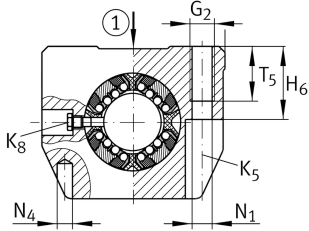
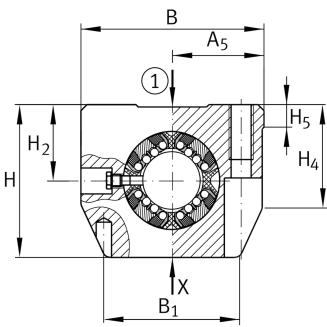

## Variante de su producto actual

Size code	12	
Seal	PP	
<b>n.r.</b>		
AS	Relubrication facility	
≈m	0,1 kg	Peso

## Medidas principales y datos de rendimiento

F <sub>w</sub>	12 mm	Diameter of ball complement
H	35 mm	Height
L	32 mm	Longitud
B	43 mm	Anchura
C <sub>max</sub>	900 N	Load capacity dyn.
C <sub>0 max</sub>	1.100 N	Load capacity stat.



## Medidas de montaje

J <sub>B</sub>	32 mm	
B <sub>1</sub>	34 mm	
A <sub>5</sub>	21,5 mm	
Tol A <sub>5</sub>	+ 0,01 mm	Upper tolerance
Tol A <sub>5</sub>	- 0,01 mm	Lower tolerance
J <sub>L</sub>	23 mm	Distance
Tol J <sub>L</sub>	+ 0,15 mm	Upper tolerance
H <sub>2</sub>	18 mm	Center height
H <sub>4</sub>	26,6 mm	
H <sub>5</sub>	5,4 mm	
T <sub>5</sub>	11 mm	Mounting Dimension
H <sub>6</sub>	16,5 mm	Mounting Dimension
G <sub>2</sub>	M5	
N <sub>1</sub>	4,3 mm	Mounting Dimension
N <sub>4</sub>	4 mm	
N <sub>3</sub>	8 mm	Mounting Dimension
K <sub>5</sub>	M4	
K <sub>8</sub>	NIP4MZ	Lubrication nipple
W	2,5 mm	Width across flats
	8	Ball rows

