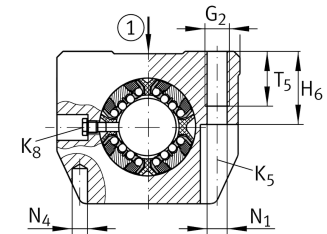
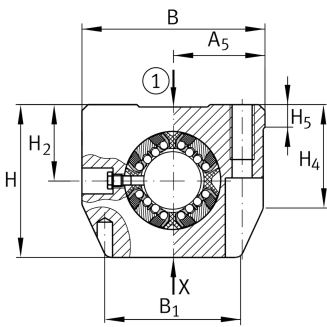

IMAGE
COMING SOON**KGSNG40-PP-AS** [↗](#)

Unidad de rodamiento lineal de bolas

Linear ball bearing and housing unit; with self-aligning linear ball bearing, sealed, greased, with relubrication facility

Información técnica



Variante de su producto actual

Seal	PP
Función de relubricación	AS

n.r.

	40	Size code
≈m	1,65 kg	Peso

Medidas principales y datos de rendimiento

F _w	40 mm	Diameter of ball complement
H	90 mm	Height
B	108 mm	Anchura
L	80 mm	Longitud
C _{max}	10.200 N	Load capacity dyn.
C _{0 max}	9.600 N	Load capacity stat.

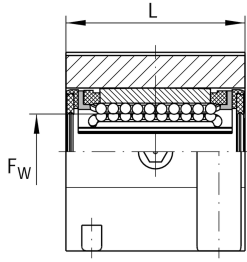
**Medidas de montaje**

J _B	86 mm	
Tol J _B	- 0,15 mm	Upper tolerance
Tol J _B	+ 0,15 mm	Lower tolerance
B ₁	76 mm	
A ₅	54 mm	
Tol A ₅	+ 0,01 mm	Upper tolerance
Tol A ₅	- 0,01 mm	Lower tolerance
J _L	58 mm	Distance
Tol J _L	+ 0,15 mm	Upper tolerance
Tol J _L	- 0,15 mm	Lower tolerance
H ₂	45 mm	Center height
Tol H ₂	+ 0,008 mm	Upper tolerance
Tol H ₂	- 0,016 mm	Lower tolerance
H ₄	57,6 mm	
H ₅	11,7 mm	
T ₅	26 mm	
H ₆	44 mm	
G ₂	M12	
N ₁	10,5 mm	
N ₄	8 mm	
N ₃	18 mm	
K ₅	M10	
K ₈	NIP5MZ	Lubrication nipple
	8	Ball rows