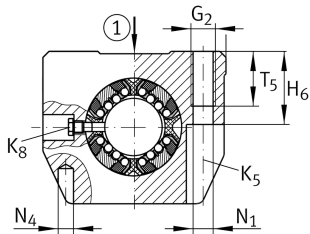
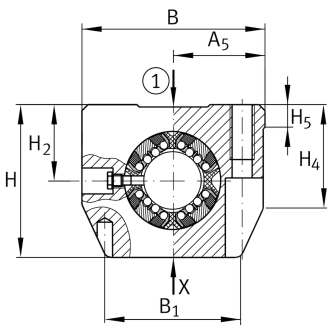

IMAGE
COMING SOON**KGSNG16-PP-AS** [↗](#)

Unidad de rodamiento lineal de bolas

Linear ball bearing and housing unit; with self-aligning linear ball bearing, sealed, greased, with relubrication facility

Información técnica



Variante de su producto actual

Seal	PP
Función de relubricación	AS
n.r.	

	16	Size code
≈m	0,19 kg	Peso

Medidas principales y datos de rendimiento

F _w	16 mm	Diameter of ball complement
H	42 mm	Height
B	53 mm	Anchura
L	37 mm	Longitud
C _{max}	1.430 N	Load capacity dyn.
C _{0 max}	1.550 N	Load capacity stat.

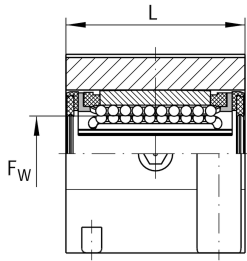

Medidas de montaje

J _B	40 mm	
Tol J _B	- 0,15 mm	Upper tolerance
Tol J _B	+ 0,15 mm	Lower tolerance
B ₁	40 mm	
A ₅	26,5 mm	
Tol A ₅	+ 0,01 mm	Upper tolerance
Tol A ₅	- 0,01 mm	Lower tolerance
J _L	26 mm	Distance
Tol J _L	+ 0,15 mm	Upper tolerance
Tol J _L	- 0,15 mm	Lower tolerance
H ₂	22 mm	Center height
Tol H ₂	+ 0,008 mm	Upper tolerance
Tol H ₂	- 0,016 mm	Lower tolerance
H ₄	29,3 mm	
H ₅	6,9 mm	
T ₅	13 mm	
H ₆	21 mm	
G ₂	M6	
N ₁	5,3 mm	
N ₄	4 mm	
N ₃	10 mm	
K ₅	M5	
K ₈	NIP4MZ	Lubrication nipple
	8	Ball rows