**KGSCS40-PP-AS**

Unidad de rodamiento lineal de bolas

Linear ball bearing and housing unit; with self-aligning linear ball bearing, open slotted design, sealed, greased, with relubrication facility

Información técnica

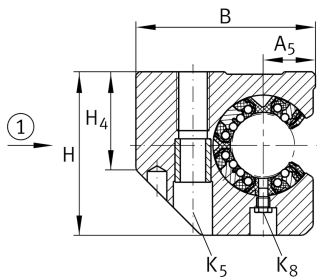

Variante de su producto actual

Size code	40	indicación de tamaño
Seal	PP	
Función de relubricación	AS	

Medidas principales y datos de rendimiento

F _w	40 mm	Diameter of ball complement
H	100 mm	Height
L	80 mm	Longitud
B	110 mm	Anchura
C _{max}	10.200 N	Load capacity dyn.
C _{0 max}	9.600 N	Load capacity stat. C _{0max}
≈m	1,9 kg	Peso

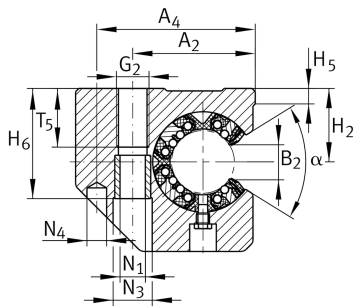

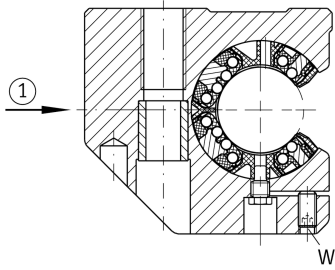
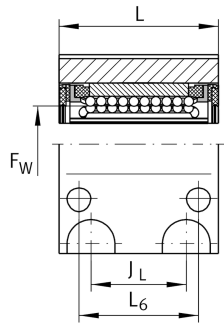
**Medidas de montaje**

A ₂	75 mm	
Tol A ₂	+ 0,15 mm	Upper tolerance
Tol A ₂	- 0,15 mm	Lower tolerance
A ₄	97 mm	
A ₅	32 mm	
Tol A ₅	+ 0,01 mm	Upper tolerance
Tol A ₅	- 0,01 mm	Lower tolerance
B ₂	18,2 mm	
J _L	48 mm	Distance
Tol J _L	+ 0,15 mm	Upper tolerance
Tol J _L	- 0,15 mm	Lower tolerance
L ₆	60 mm	Distance
H ₂	45 mm	Center height
Tol H ₂	+ 0,008 mm	Upper tolerance
Tol H ₂	- 0,016 mm	Lower tolerance
H ₄	60 mm	
H ₅	9,5 mm	
T ₅	36 mm	Mounting Dimension
H ₆	67,6 mm	
G ₂	M20	
N ₁	15,5 mm	
N ₄	12 mm	
N ₃	24 mm	
K ₅	M14	
K ₈	NIP5MZ	Lubrication nipple
W	4 mm	Width across flats
α	56 °	Angle
	6	Ball rows