**KGSCS20-PP-AS**

Unidad de rodamiento lineal de bolas

Linear ball bearing and housing unit; with self-aligning linear ball bearing, open slotted design, sealed, greased, with relubrication facility

Información técnica

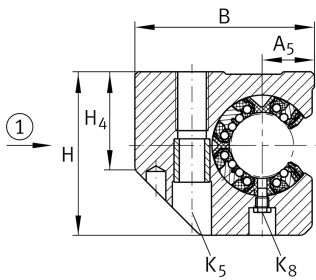

Variante de su producto actual

Size code	20
Seal	PP
Función de relubricación	AS

Medidas principales y datos de rendimiento

F _W	20 mm	Diameter of ball complement
H	60 mm	Height
L	47 mm	Longitud
B	60 mm	Anchura
C _{max}	2.200 N	Load capacity dyn.
C _{0 max}	2.310 N	Load capacity stat. C _{0max}
≈m	0,36 kg	Peso

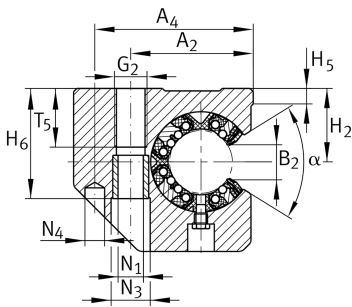

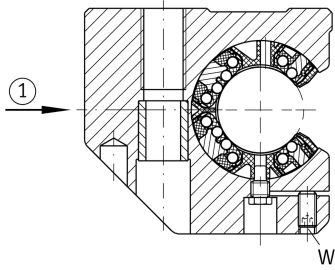
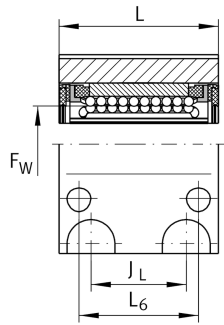
**Medidas de montaje**

A ₂	39 mm	
Tol A ₂	+ 0,15 mm	Upper tolerance
Tol A ₂	- 0,15 mm	Lower tolerance
A ₄	51 mm	
A ₅	17 mm	
Tol A ₅	+ 0,01 mm	Upper tolerance
Tol A ₅	- 0,01 mm	Lower tolerance
B ₂	10 mm	
J _L	30 mm	Distance
Tol J _L	+ 0,15 mm	Upper tolerance
Tol J _L	- 0,15 mm	Lower tolerance
L ₆	36 mm	Distance
H ₂	30 mm	Center height
Tol H ₂	+ 0,008 mm	Upper tolerance
Tol H ₂	- 0,016 mm	Lower tolerance
H ₄	37,5 mm	
H ₅	8,3 mm	
T ₅	18 mm	Mounting Dimension
H ₆	42,6 mm	
G ₂	M10	
N ₁	8,4 mm	
N ₄	6 mm	
N ₃	15 mm	
K ₅	M8	
K ₈	NIP4MZ	Lubrication nipple
W	2,5 mm	Width across flats
α	55 °	Angle
	6	Ball rows