

**MKUSE25-200-KGT-OA-WN2**

## Módulo lineal

Actuators with six-row linear recirculating bearing and guideway assembly, monorail guidance system and ball screw drive. With second, non-driven carriage, without ball screw drive (no spindle)

## Información técnica

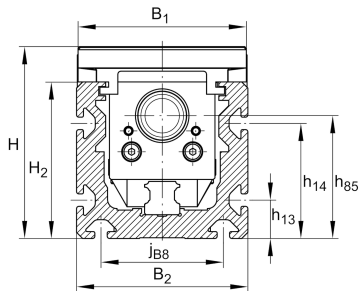

## Variante de su producto actual

Size code	25	
Length of carriage	200	200 mm
Drive type	OA	Without drive
Additional carriage	WN2	Second, non-driven carriage
Spindle support	/	None
Attachment to the carriage	/	Threaded holes

## Medidas principales y datos de rendimiento

L	200 mm	Length of Carriage
H	125 mm	Total Height
B 2	112 mm	Total Width

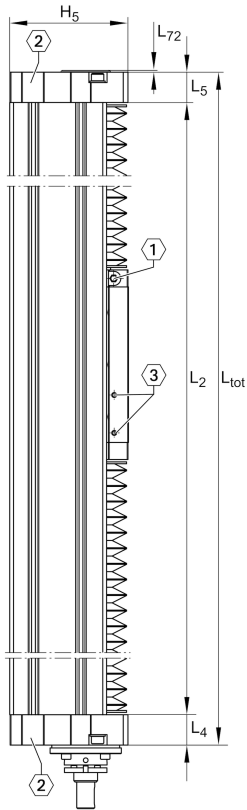

### Medidas de montaje

B 1	110 mm	Width of Carriage
G 43	M10	Thread
h 13	25 mm	
h 14	75 mm	
J B43	80 mm	
Tol J B43	0,1	Upper Tolerance
Tol J B43	-0,1	Lower Tolerance
J L43	110 mm	Tolerance $\pm 0,2$
j B8	80 mm	
L 2 max	5.850 mm	Maximum length of Support Rail
t 43	20 mm	Depth of Thread

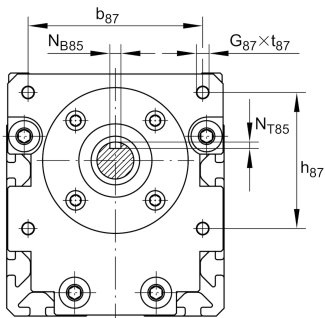

### Medidas

B 5	111 mm	Width of End Plates
F BL	1,2	Effective length factor of bellow
H 2	102 mm	Width of Support Rail
H 5	124,5 mm	
L 4	32 mm	
L 5	32 mm	
L 72	2 mm	
L x1 min	20 mm	Minimum distance between the Carriages

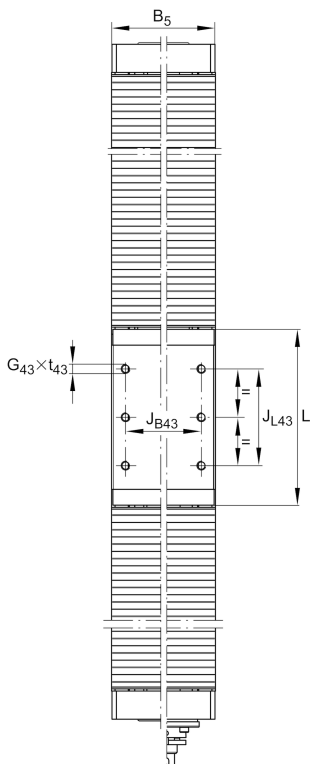

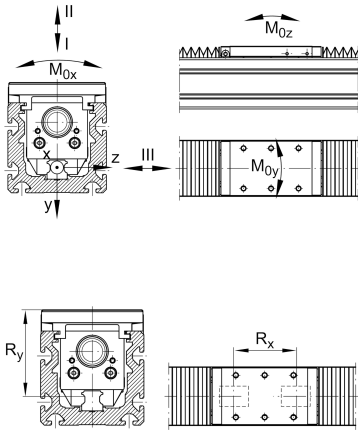
**Datos técnicos**

$R_x$	83,3 mm	
$R_y$	93,8 mm	
S	10 mm	Safety Distance
$m_{LAW}$	3,37 kg	Mass of Carriage
$m_3$	3,37 kg	Mass of additional Carriage
IC	61.700 N	Load direction I: compressive load
I C <sub>0</sub>	162.000 N	Load direction I: compressive load
II C	42.200 N	Load direction II: tensile load
II C <sub>0</sub>	90.000 N	Load direction II: tensile load
III C	45.400 N	Load direction III: lateral load
III C <sub>0</sub>	94.000 N	Load direction III: lateral load
$M_{0x \text{ per}}$	1.350 Nm	Max. permissible static moment per Carriage
$M_{0y \text{ per}}$	1.850 Nm	Max. permissible static moment per Carriage
$M_{0z \text{ per}}$	2.000 Nm	Max. permissible static moment per Carriage
$I_y$	670 cm <sup>4</sup>	Geometrical moments of inertia of Support Rail
$I_z$	384 cm <sup>4</sup>	Geometrical moments of inertia of Support Rail
WN2	Ja	Second, non-driven Carriage

**Información adicional**

2xKWSE25

Carriage