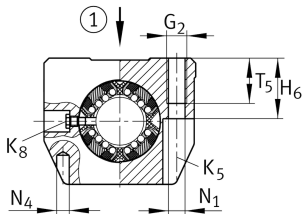
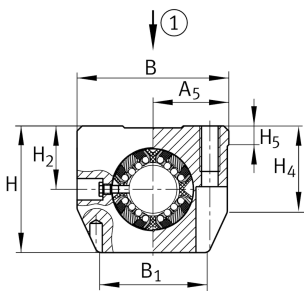

IMAGE  
COMING SOON**KTSG20-PP-AS** [↗](#)

Unidad de rodamiento lineal de bolas

Linear ball bearing and housing unit; with self-aligning linear ball bearing, contact seals on both sides

## Información técnica



## Variante de su producto actual

|             |    |
|-------------|----|
| Size code   | 20 |
| Seal        | PP |
| <b>n.r.</b> |    |

AS

Relubrication facility

≈m

0,56 kg

Peso

## Medidas principales y datos de rendimiento

|                    |         |                             |
|--------------------|---------|-----------------------------|
| F <sub>w</sub>     | 20 mm   | Diameter of ball complement |
| H                  | 50 mm   | Height                      |
| L                  | 96 mm   | Longitud                    |
| B                  | 60 mm   | Anchura                     |
| C <sub>max</sub>   | 3.500 N | Load capacity dyn.          |
| C <sub>0 max</sub> | 4.600 N | Load capacity stat.         |

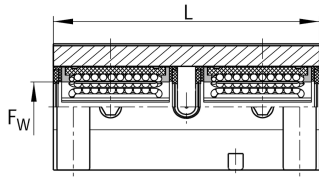
**Medidas de montaje**

|                    |            |                    |
|--------------------|------------|--------------------|
| J <sub>B</sub>     | 45 mm      |                    |
| Tol J <sub>B</sub> | + 0,15 mm  | Upper tolerance    |
| Tol J <sub>B</sub> | - 0,15 mm  | Lower tolerance    |
| B <sub>1</sub>     | 44 mm      |                    |
| A <sub>5</sub>     | 30 mm      | Mounting Dimension |
| Tol A <sub>5</sub> | + 0,01 mm  | Upper tolerance    |
| Tol A <sub>5</sub> | - 0,01 mm  | Lower tolerance    |
| J <sub>L</sub>     | 76 mm      | Distance           |
| Tol J <sub>L</sub> | + 0,15 mm  | Upper tolerance    |
| Tol J <sub>L</sub> | - 0,15 mm  | Lower tolerance    |
| L <sub>6</sub>     | 33 mm      | Distance           |
| H <sub>2</sub>     | 25 mm      | Center height      |
| Tol H <sub>2</sub> | + 0,008 mm | Upper tolerance    |
| Tol H <sub>2</sub> | - 0,016 mm | Lower tolerance    |
| H <sub>4</sub>     | 34,1 mm    | Mounting Dimension |
| H <sub>5</sub>     | 7,4 mm     |                    |
| T <sub>5</sub>     | 18 mm      | Mounting Dimension |
| H <sub>6</sub>     | 24 mm      |                    |
| G <sub>2</sub>     | M8         |                    |
| N <sub>1</sub>     | 6,6 mm     | Mounting Dimension |
| N <sub>4</sub>     | 5 mm       |                    |
| N <sub>3</sub>     | 11 mm      |                    |
| K <sub>5</sub>     | M6         |                    |
| K <sub>8</sub>     | NIP4MZ     | Lubrication nipple |
|                    | 8          | Ball rows          |