

**KTSG16-PP-AS** [↗](#)

Unidad de rodamiento lineal de bolas

Linear ball bearing and housing unit; with self-aligning linear ball bearing, contact seals on both sides

## Información técnica

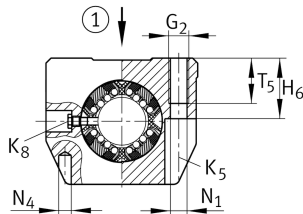
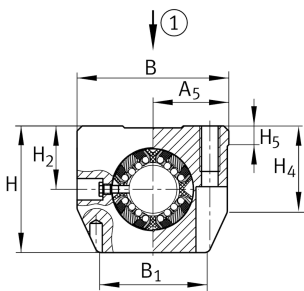

## Variante de su producto actual

Size code	16	indicación de tamaño
Seal	PP	
<b>n.r.</b>		

AS Relubrication facility

≈m 0,35 kg Peso

## Medidas principales y datos de rendimiento

F <sub>w</sub>	16 mm	Diameter of ball complement
H	42 mm	Height
L	78 mm	Longitud
B	53 mm	Anchura
C <sub>max</sub>	2.330 N	Load capacity dyn.
C <sub>0 max</sub>	3.100 N	Load capacity stat.

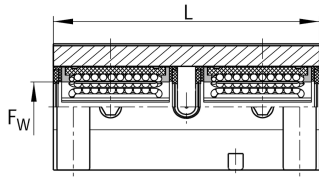
**Medidas de montaje**

J <sub>B</sub>	40 mm	
Tol J <sub>B</sub>	+ 0,15 mm	Upper tolerance
Tol J <sub>B</sub>	- 0,15 mm	Lower tolerance
B <sub>1</sub>	40 mm	
A <sub>5</sub>	26,5 mm	Mounting Dimension
Tol A <sub>5</sub>	+ 0,01 mm	Upper tolerance
Tol A <sub>5</sub>	- 0,01 mm	Lower tolerance
J <sub>L</sub>	64 mm	Distance
Tol J <sub>L</sub>	+ 0,15 mm	Upper tolerance
Tol J <sub>L</sub>	- 0,15 mm	Lower tolerance
L <sub>6</sub>	26 mm	Distance
H <sub>2</sub>	22 mm	Center height
Tol H <sub>2</sub>	+ 0,008 mm	Upper tolerance
Tol H <sub>2</sub>	- 0,016 mm	Lower tolerance
H <sub>4</sub>	29,3 mm	Mounting Dimension
H <sub>5</sub>	6,9 mm	
T <sub>5</sub>	13 mm	Mounting Dimension
H <sub>6</sub>	21 mm	
G <sub>2</sub>	M6	
N <sub>1</sub>	5,3 mm	Mounting Dimension
N <sub>4</sub>	4 mm	
N <sub>3</sub>	10 mm	
K <sub>5</sub>	M5	
K <sub>8</sub>	NIP4MZ	Lubrication nipple
	8	Ball rows