

**KTHK50-B-PP-AS** [↗](#)

## Unidad de rodamiento lineal de bolas

Linear ball bearing and housing unit; sealed, greased, with relubrication facility; corrosion-resistant design possible

## Información técnica

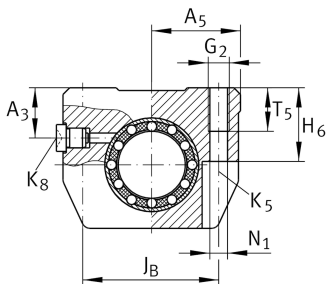
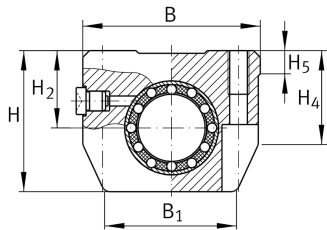

## Variante de su producto actual

Size code	50
Version	B
Seal	PP
Función de relubricación	AS

## Medidas principales y datos de rendimiento

F <sub>W</sub>	50 mm	Diameter of ball complement
H	92 mm	Height
L	145 mm	Longitud
B	103 mm	Anchura
C	11.000 N	Load capacity dyn. C
C <sub>0</sub>	12.600 N	Load capacity stat. C <sub>0</sub>
≈m	2,05 kg	Peso

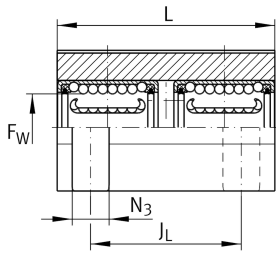
**Medidas de montaje**

J <sub>B</sub>	82 mm	
Tol J <sub>B</sub>	+ 0,15 mm	Upper tolerance
Tol J <sub>B</sub>	- 0,15 mm	Lower tolerance
B <sub>1</sub>	74 mm	
A <sub>5</sub>	51,5 mm	
J <sub>L</sub>	100 mm	Distance
Tol J <sub>L</sub>	+ 0,15 mm	Upper tolerance
Tol J <sub>L</sub>	- 0,15 mm	Lower tolerance
H <sub>2</sub>	47 mm	Center height
Tol H <sub>2</sub>	+ 0,01 mm	Upper tolerance
Tol H <sub>2</sub>	- 0,014 mm	Lower tolerance
H <sub>4</sub>	62,3 mm	
H <sub>5</sub>	10,9 mm	
T <sub>5</sub>	26 mm	
H <sub>6</sub>	46 mm	
A <sub>3</sub>	28 mm	
G <sub>2</sub>	M12	
N <sub>1</sub>	10,5 mm	
N <sub>3</sub>	20 mm	
K <sub>5</sub>	M10	
K <sub>8</sub>	NIPA2	Lubrication nipple