

**KTHK12-B-PP-AS** [↗](#)

Unidad de rodamiento lineal de bolas

Linear ball bearing and housing unit; sealed, greased, with relubrication facility; corrosion-resistant design possible

Información técnica

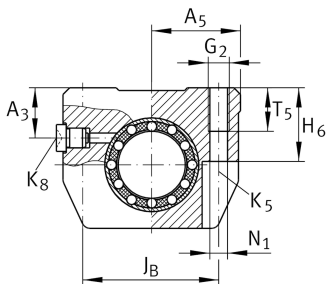
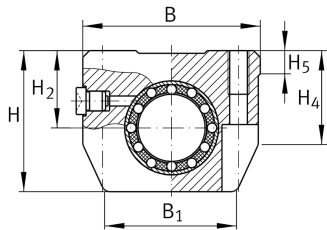

Variante de su producto actual

Size code	12
Version	B
Seal	PP
Función de relubricación	AS

Medidas principales y datos de rendimiento

F _W	12 mm	Diameter of ball complement
H	33 mm	Height
L	60 mm	Longitud
B	40 mm	Anchura
C	1.090 N	Load capacity dyn. C
C ₀	1.020 N	Load capacity stat. C ₀
≈m	0,13 kg	Peso

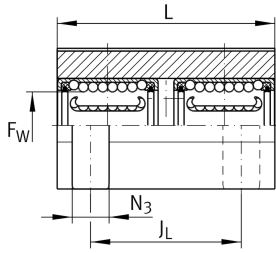
**Medidas de montaje**

J _B	29 mm	
Tol J _B	+ 0,15 mm	Upper tolerance
Tol J _B	- 0,15 mm	Lower tolerance
B ₁	32 mm	
A ₅	20 mm	
J _L	35 mm	Distance
Tol J _L	+ 0,15 mm	Upper tolerance
Tol J _L	- 0,15 mm	Lower tolerance
H ₂	17 mm	Center height
Tol H ₂	+ 0,01 mm	Upper tolerance
Tol H ₂	- 0,014 mm	Lower tolerance
H ₄	25,1 mm	
H ₅	5 mm	
T ₅	11 mm	
H ₆	16 mm	
A ₃	11 mm	
G ₂	M5	
N ₁	4,3 mm	
N ₃	10 mm	
K ₅	M4	
K ₈	NIPA1	Lubrication nipple