**KUVE35-B**

Sistema con recirculación a bolas

Carriages KWVE...-B, standard carriage, four-row, full complement ball set

## Información técnica



## Variante de su producto actual

|                 |          |                   |
|-----------------|----------|-------------------|
| Size code       | 35       |                   |
| Carriage design | Standard | Standard carriage |
| Version         | B        |                   |

## Medidas principales

|           |          |                                  |
|-----------|----------|----------------------------------|
| $l_{max}$ | 5.860 mm | Max length single piece guideway |
| H         | 48 mm    | Altura sistema                   |
| B         | 100 mm   | Width carriage                   |
| L         | 112 mm   | Overall length carriage          |

## Datos técnicos

|          |          |   |
|----------|----------|---|
| C        | 38.000 N | Capacidad de carga dinámica                     |
| $C_0$    | 72.000 N | Static load rating                              |
| $M_{0x}$ | 1.465 Nm | Capacidad de momento estático momento del eje X |
| $M_{0y}$ | 1.020 Nm | Capacidad de momento estático del eje Y         |
| $M_{0z}$ | 1.020 Nm | Capacidad de momento estático del eje Z         |

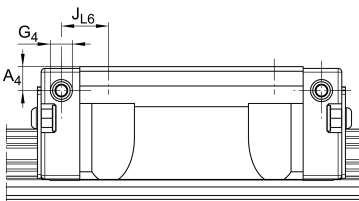
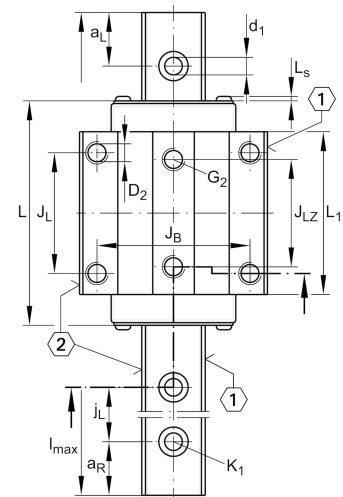

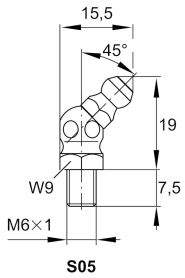
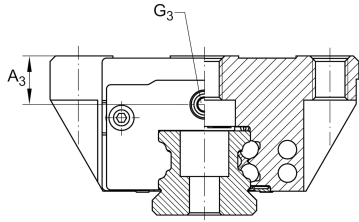

**Medidas de montaje**

|                    |           |                           |
|--------------------|-----------|---------------------------|
| A <sub>1</sub>     | 33 mm     |                           |
| J <sub>B</sub>     | 82 mm     |                           |
| b                  | 34 mm     | Anchura de la guía        |
| Tol <sub>b</sub>   | -0,005 mm | Tolerancia superior       |
| Tol <sub>b</sub>   | -0,03 mm  | Lower tolerance           |
| A <sub>2</sub>     | 9 mm      |                           |
| L <sub>1</sub>     | 80 mm     |                           |
| L <sub>s</sub>     | 1,65 mm   |                           |
| J <sub>L</sub>     | 62 mm     |                           |
| J <sub>LZ</sub>    | 52 mm     |                           |
| j <sub>L</sub>     | 80 mm     |                           |
| a <sub>L min</sub> | 20 mm     |                           |
| a <sub>L max</sub> | 71 mm     |                           |
| a <sub>R min</sub> | 20 mm     |                           |
| a <sub>R max</sub> | 71 mm     |                           |
| H <sub>1</sub>     | 6,7 mm    |                           |
| H <sub>4</sub>     | 14,3 mm   |                           |
| H <sub>5</sub>     | 6,75 mm   |                           |
| T <sub>5</sub>     | 13 mm     |                           |
| T <sub>6</sub>     | 12,3 mm   |                           |
| h                  | 27 mm     |                           |
| h <sub>1</sub>     | 14,5 mm   |                           |
| G <sub>2</sub>     | M10       | Fixing screws             |
| G <sub>2 MA</sub>  | 41 Nm     | Maximum tightening torque |
| K <sub>1</sub>     | M8        | Fixing screws             |
| K <sub>1 MA</sub>  | 41 Nm     | Maximum tightening torque |
| K <sub>3</sub>     | M8        | Fixing screws             |
| K <sub>3 MA</sub>  | 41 Nm     | Par de apriete máximo     |
| K <sub>6</sub>     | M8        | Fixing screws             |



Ver detalles del producto en Medias

11.11.2025, 17:06:01 UTC

**SCHAEFFLER**

### Productos relacionados

---

KWVE35-B

Compatible with the following carriage

TKVD35

Suitable Guide Rail