



### MKUVE25-250-ZR-W2-FA517.1 [↗](#)

#### Módulo lineal

Actuators with four-row linear recirculating ball bearing and guideway assembly, monorail guidance system and toothed belt drive. With support rail in two segments and second, driven carriage

### Información técnica

#### Variante de su producto actual

|                            |       |                         |
|----------------------------|-------|-------------------------|
| Size code                  | 25    |                         |
| Length of carriage         | 250   | 250 mm                  |
| Ejecución                  | /     | Basis                   |
| Drive type                 | (3)ZR | Toothed belt drive      |
| Additional carriage        | W2    | Second, driven carriage |
| Attachment to the carriage | /     | Threaded holes          |

#### n.r.

|         |                     |
|---------|---------------------|
| FA517.1 | Support Rail Design |
|---------|---------------------|

#### Medidas principales y datos de rendimiento

|     |        |                    |
|-----|--------|--------------------|
| B 2 | 112 mm | Total Width        |
| H   | 125 mm | Total Height       |
| L   | 250 mm | Length of Carriage |

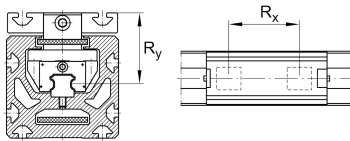
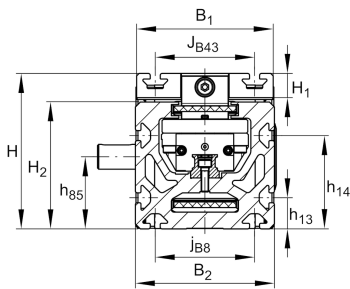

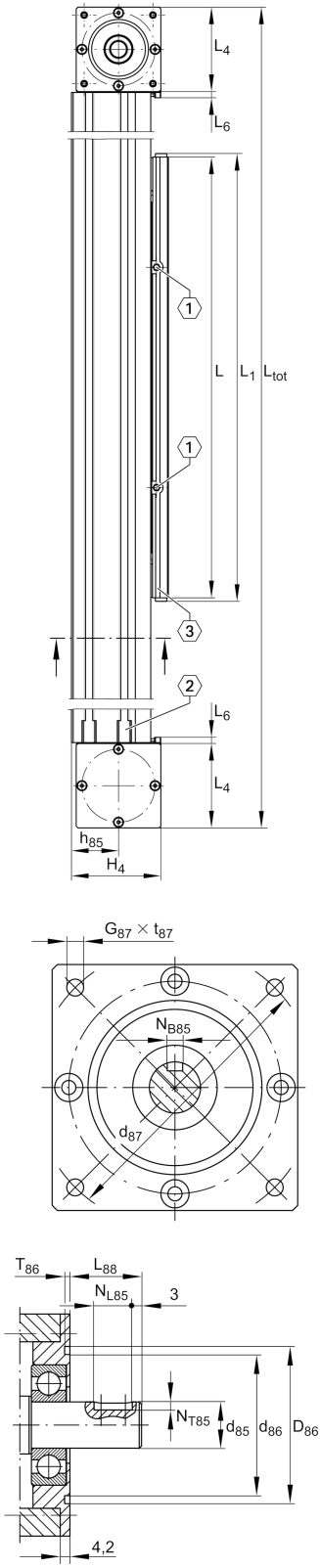

**Medidas de montaje**

|           |           |                                |
|-----------|-----------|--------------------------------|
| B 1       | 110 mm    | Width of Carriage              |
| D 86      | 95 mm     |                                |
| Tol D 86  | G7        | Tolerance                      |
| D 87      | 115 mm    |                                |
| d 85      | 20 mm     | Tolerance h7                   |
| d 86      | 76 mm     |                                |
| G 43      | M10       |                                |
| G 87      | M8        |                                |
| h 13      | 25 mm     |                                |
| h 14      | 75 mm     |                                |
| h 18      | 5 mm      |                                |
| J B43     | 80 mm     |                                |
| Tol J B43 | 0,1       | Upper Tolerance                |
| Tol J B43 | 0,1       | Lower Tolerance                |
| J L43     | 180 mm    |                                |
| j B8      | 80 mm     |                                |
| L 2 max   | 16.000 mm | Maximum length of Support Rail |
| L 88      | 31 mm     |                                |
| N B85     | 6 mm      | Tolerance P9                   |
| N L85     | 25 mm     | Length of Keyway               |
| N T85     | 3,5 mm    | Depth of Keyway                |
| t 43 max  | 20 mm     | Depth of Thread                |
| t 87 max  | 15 mm     | Depth of Thread                |

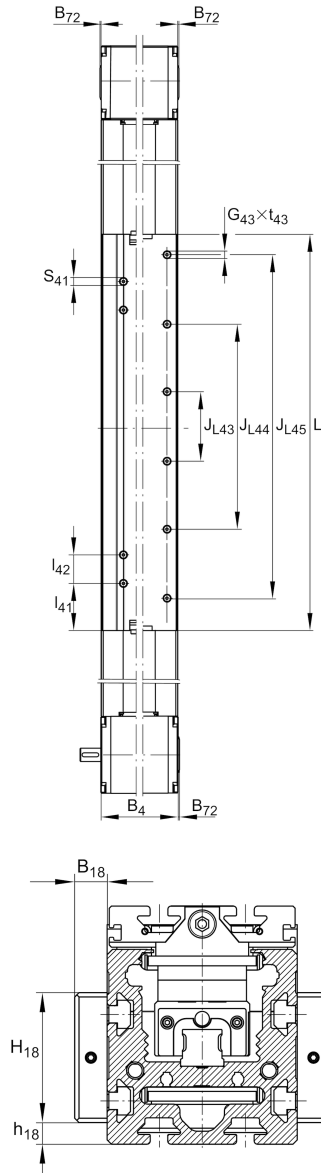

### Medidas

|          |          |                         |
|----------|----------|-------------------------|
| B 18     | 15 mm    |                         |
| B 72     | 2 mm     |                         |
| H 1      | 21 mm    | Height of Carriage      |
| H 2      | 102 mm   | Height of Support Rail  |
| H 4      | 115,7 mm | Height of Return Unit   |
| H 18     | 90 mm    |                         |
| h 85     | 58 mm    |                         |
| L 1      | 263 mm   |                         |
| L 4      | 115,5 mm | Length of Return Unit   |
| L 6      | 6 mm     | Length of Wiper Brushes |
| L 18     | 400 mm   |                         |
| L x1 min | 50 mm    |                         |
| B 4      | 111 mm   | Width of Return Unit    |
| T 86     | 4 mm     | Depth Fit               |
| Tol T 86 | 0 mm     | Lower tolerance         |
| Tol T 86 | 0,5 mm   | Upper Tolerance         |

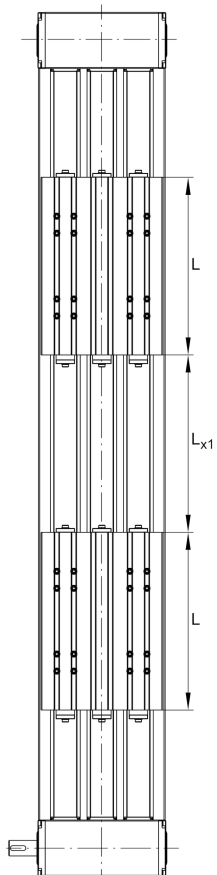
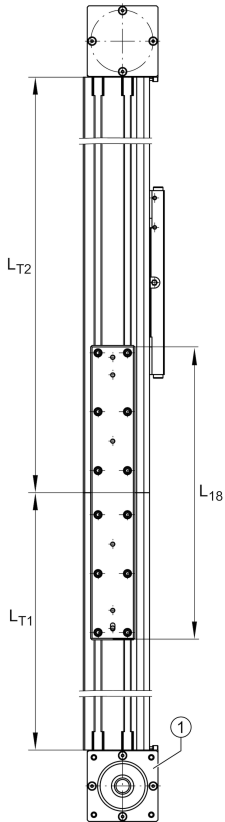

### Datos técnicos

|                      |                     |  |
|----------------------|---------------------|--|
| $R_x$                | 110 mm              |  |
| $R_y$                | 71,8 mm             |  |
| S                    | 85 mm               | Safety Distance                                |
| $m_{LAW}$            | 4,31 kg             |  |
| $m_3$                | 4,31 kg             | Mass of additional Carriage                    |
| $v_{max}$            | 5 m/s               | Maximum Speed                                  |
| $a_{max}$            | 30 m/s <sup>2</sup> | Maximum Acceleration                           |
| I C                  | 29.000 N            | Load direction I: compressive load             |
| I C <sub>0</sub>     | 74.000 N            | Load direction I: compressive load             |
| II C                 | 29.000 N            | Load direction II: tensile load                |
| II C <sub>0</sub>    | 74.000 N            | Load direction II: tensile load                |
| III C                | 29.000 N            | Load direction III: lateral load               |
| III C <sub>0</sub>   | 74.000 N            | Load direction III: lateral load               |
| $M_{0x \text{ per}}$ | 1.000 Nm            | Max. permissible static moment per Carriage    |
| $M_{0y \text{ per}}$ | 2.575 Nm            | Max. permissible static moment per Carriage    |
| $M_{0z \text{ per}}$ | 2.575 Nm            | Max. permissible static moment per Carriage    |
| $I_y$                | 712 cm <sup>4</sup> | Geometrical moments of inertia of Support Rail |
| $I_z$                | 506 cm <sup>4</sup> | Geometrical moments of inertia of Support Rail |

### Información adicional

|                         |  |
|-------------------------|--|
| 75 Nm                   | Max. permissible drive torque            |
| 2xKWVE25-B              | Carriage                                 |
| 0,1 mm                  | Repeat Accuracy ±                        |
| 250 mm                  | Feed (mm/rotation)                       |
| 50AT10                  | Toothed Belt                             |
| 0,29 kg/m               | Mass of Toothed Belt                     |
| 1.880 N                 | Permissible Toothed Belt operating force |
| 14,7 kg*cm <sup>2</sup> | Mass moment of inertia of Gears          |

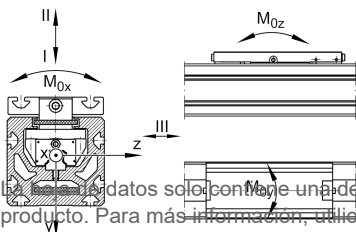



### Rango de temperatura

---

|     |       |                              |
|-----|-------|------------------------------|
| max | 80 °C | Maximum operating Temperatur |
| min | 0 °C  | Minimum operating Temperatur |