**MKUVE20-500-C-LN-ZR-W2-N-FA517.2** [↗](#)

Módulo lineal

Actuators with four-row linear recirculating ball bearing and guideway assembly, monorail guidance system and toothed belt drive. Low Noise design with support rail in three segments and second, driven carriage

Información técnica

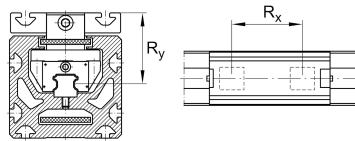
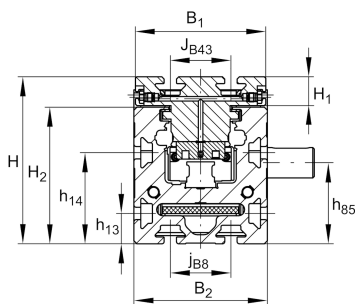

Variante de su producto actual

| | | |
|----------------------------|-------|-------------------------|
| Size code | 20 | |
| Length of carriage | 500 | 500 mm |
| Ejecución | LN | Low-Noise |
| Drive type | (3)ZR | Toothed belt drive |
| Additional carriage | W2 | Second, driven carriage |
| Attachment to the carriage | N | T-Slots |

n.r.

FA517.2

Support Rail Design

Medidas principales y datos de rendimiento

| | | |
|-----|--------|--------------------|
| B 2 | 88 mm | Total Width |
| H | 110 mm | Total Height |
| L | 500 mm | Length of Carriage |

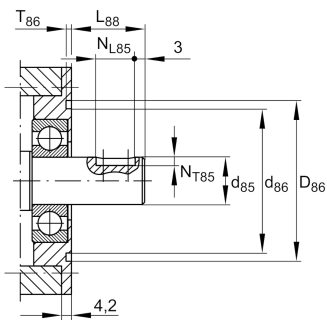
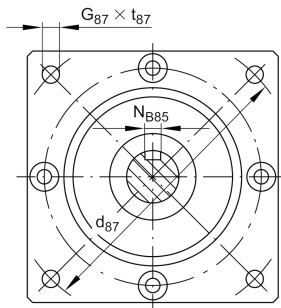

Medidas de montaje

| | | |
|----------|-----------|--------------------------------|
| B 1 | 86 mm | Width of Carriage |
| D 86 | 68 mm | |
| Tol D 86 | G7 | Tolerance |
| D 87 | 110 mm | |
| d 85 | 20 mm | Tolerance h7 |
| d 86 | 61 mm | |
| G 87 | M6 | |
| h 13 | 20 mm | |
| h 14 | 60 mm | |
| h 18 | 10 mm | |
| J B43 | 40 mm | |
| j B8 | 40 mm | |
| L 2 max | 24.000 mm | Maximum length of Support Rail |
| L 88 | 31 mm | |
| N B85 | 6 mm | Tolerance P9 |
| N L85 | 25 mm | Length of Keyway |
| N T85 | 3,5 mm | Depth of Keyway |
| S 41 | 10 mm | |
| t 87 max | 24 mm | Depth of Thread |

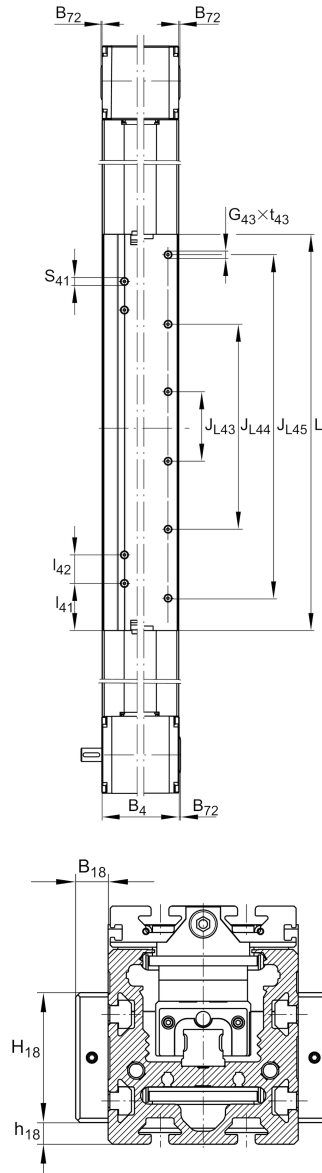

Medidas

| | | |
|----------|----------|-------------------------|
| B 18 | 15 mm | |
| H 1 | 19 mm | Height of Carriage |
| H 2 | 90 mm | Height of Support Rail |
| H 4 | 101,4 mm | Height of Return Unit |
| H 18 | 60 mm | |
| h 85 | 53,4 mm | |
| L 1 | 510 mm | |
| L 4 | 97 mm | Length of Return Unit |
| L 6 | 6 mm | Length of Wiper Brushes |
| L 18 | 400 mm | |
| l 41 | 59,5 mm | |
| l 42 | 36 mm | |
| L x1 min | 50 mm | |
| B 4 | 89 mm | Width of Return Unit |
| T 86 | 2,3 mm | Depth Fit |
| Tol T 86 | 0 mm | Lower tolerance |
| Tol T 86 | 0,3 mm | Upper Tolerance |

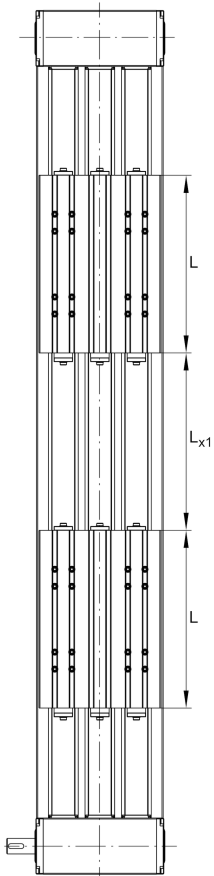
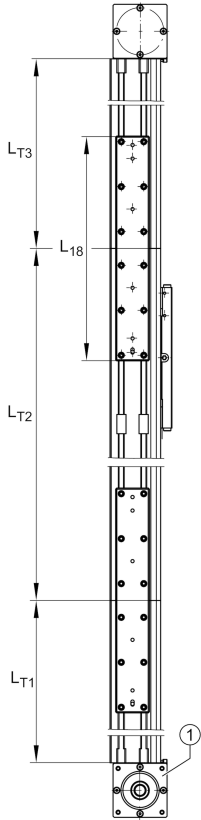

Datos técnicos

| | | |
|----------------------|---------------------|--|
| R_x | 345 mm | |
| R_y | 63 mm | |
| S | 85 mm | Safety Distance |
| m_{LAW} | 4,07 kg | |
| m_3 | 4,07 kg | Mass of additional Carriage |
| v_{max} | 5 m/s | Maximum Speed |
| a_{max} | 30 m/s ² | Maximum Acceleration |
| I C | 21.300 N | Load direction I: compressive load |
| I C ₀ | 54.000 N | Load direction I: compressive load |
| II C | 21.300 N | Load direction II: tensile load |
| II C ₀ | 54.000 N | Load direction II: tensile load |
| III C | 21.300 N | Load direction III: lateral load |
| III C ₀ | 54.000 N | Load direction III: lateral load |
| $M_{0x \text{ per}}$ | 664 Nm | Max. permissible static moment per Carriage |
| $M_{0y \text{ per}}$ | 5.800 Nm | Max. permissible static moment per Carriage |
| $M_{0z \text{ per}}$ | 7.100 Nm | Max. permissible static moment per Carriage |
| I_y | 300 cm ⁴ | Geometrical moments of inertia of Support Rail |
| I_z | 198 cm ⁴ | Geometrical moments of inertia of Support Rail |

Información adicional

| | |
|----------------------|--|
| 68,8 Nm | Max. permissible drive torque |
| 2xKWVE20-B-SN | Carriage |
| 0,1 mm | Repeat Accuracy ± |
| 200 mm | Feed (mm/rotation) |
| 50BATAK10 | Toothed Belt |
| 0,29 kg/m | Mass of Toothed Belt |
| 1.880 N | Permissible Toothed Belt operating force |
| 5 kg*cm ² | Mass moment of inertia of Gears |

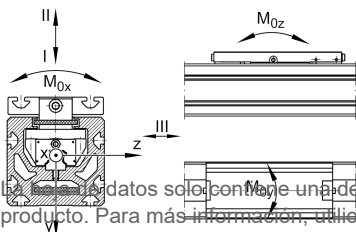



Rango de temperatura

| | | |
|-----|-------|------------------------------|
| max | 80 °C | Maximum operating Temperatur |
| min | 0 °C | Minimum operating Temperatur |