

LFDL32-B [↗](#)

Carro

bogie carriage

Información técnica

Variante de su producto actual

Size code	32
Setting	B

Medidas principales y datos de rendimiento

H ₁	43 mm	
B	80 mm	
L	100 mm	
≈m	0,8 kg	Peso

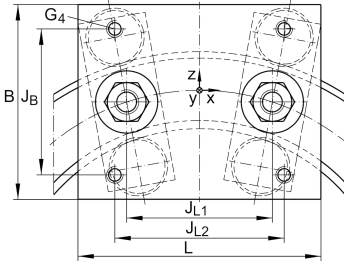
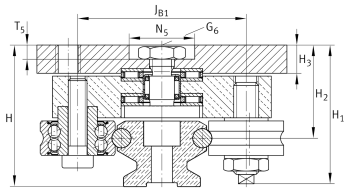

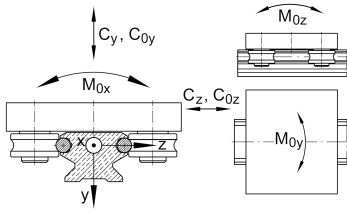

Medidas de montaje

G 4	M8	
G 6	M8	
H	44,2 mm	Total height of carriage and rail at LFS, -C, -CE, -CEE, -E, -EE, -N, -NZZ
H 2	29,2 mm	
H 2 Tol	0,3	
H 2 Tol	0	
H 3	9 mm	
J B	60 mm	
J B1	54 mm	
J L1	60 mm	
J L2	70 mm	
N 5	21 mm	
T 5	5 mm	

Medidas principales

M A	15 Nm	Tightening torque (standard version)
C y	4.100 N	Basic dynamic load rating in y-direction
C 0y	2.400 N	Basic static load rating in y-direction
C z	6.600 N	Basic dynamic load rating in z-direction
C 0z	4.200 N	Basic static load rating in z-direction
M 0x	30 Nm	Static moment about X-axis
M 0y	130 Nm	Static moment about Y-axis
M 0z	70 Nm	Static moment about Z-axis

Productos relacionados

LFR	LFR50/8-6-2Z	Used track roller
LFS	LFS32	Guide rail