

KTFS12-PP-AS [↗](#)

Unidad de rodamiento lineal de bolas

Linear ball bearing and housing unit; with self-aligning linear ball bearing, sealed, greased, with relubrication facility

Información técnica

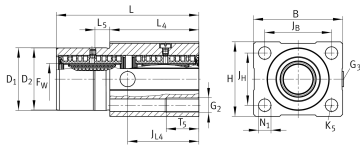

Variante de su producto actual

| | |
|--------------------------|----|
| Size code | 12 |
| Seal | PP |
| Función de relubricación | AS |

Medidas principales y datos de rendimiento

| | | |
|--------------------|---------|------------------------------------|
| F _W | 12 mm | Diameter of ball complement |
| H | 34 mm | Height |
| L | 70 mm | Longitud |
| B | 42 mm | Anchura |
| C _{min} | 1.020 N | Load capacity dyn. C |
| C _{0 min} | 1.200 N | Load capacity stat. C ₀ |
| m | 0,2 kg | Peso |

**Medidas de montaje**

| | | |
|--------------------|-----------|-----------------|
| J _B | 32 mm | |
| Tol J _B | + 0,15 mm | Upper tolerance |
| Tol J _B | - 0,15 mm | Lower tolerance |
| L ₄ | 46 mm | |
| L ₅ | 10 mm | |
| J _{L4} | 35 mm | Distance |
| D ₁ | 30 mm | Diameter |
| Tol D ₁ | g7 | Tolerance |
| D ₂ | 30 mm | Diameter |
| Tol D ₂ | - 0,1 mm | Upper tolerance |
| Tol D ₂ | - 0,3 mm | Lower tolerance |
| J _H | 24 mm | |
| Tol J _H | + 0,15 mm | Upper tolerance |
| Tol J _H | - 0,15 mm | Lower tolerance |
| T ₅ | 13 mm | Thread depth |
| G ₂ | M6 | Thread size |
| N ₁ | 5,3 mm | Diameter |
| K ₅ | M5 | |
| G ₃ | M8x1 | Thread size |
| | 8 | Ball rows |