**KGB40-PP-AS** [↗](#)

## Unidad de rodamiento lineal de bolas

Linear ball bearing and housing unit; sealed, greased, with relubrication facility; corrosion-resistant design possible

## Información técnica

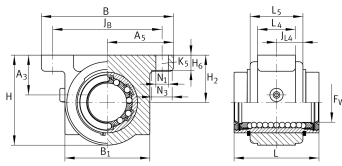

## Variante de su producto actual

|                          |    |                      |
|--------------------------|----|----------------------|
| Size code                | 40 | indicación de tamaño |
| Seal                     | PP |                      |
| Función de relubricación | AS |                      |

## Medidas principales y datos de rendimiento

|             |            |                             |
|-------------|------------|-----------------------------|
| $F_W$       | 40 mm      | Diameter of ball complement |
| Tol $F_W$   | + 0,013 mm | Upper tolerance             |
| Tol $F_W$   | - 0,002 mm | Lower tolerance             |
| H           | 83,5 mm    | Height                      |
| L           | 80 mm      | Longitud                    |
| Tol L       | h12        | Tolerance                   |
| B           | 108 mm     | Width                       |
| C           | 6.000 N    | Load capacity dyn.          |
| $C_0$       | 4.400 N    | Load capacity stat.         |
| $\approx m$ | 1,401 kg   | Peso                        |



### Medidas de montaje

|                    |            |  |
|--------------------|------------|--|
| J <sub>B</sub>     | 94 mm      |  |
| Tol J <sub>B</sub> | + 0,2 mm   | Upper tolerance                                    |
| Tol J <sub>B</sub> | - 0,2 mm   | Lower tolerance                                    |
| B <sub>1</sub>     | 77 mm      |  |
| A <sub>5</sub>     | 54 mm      |  |
| Tol A <sub>5</sub> | + 0,02 mm  | Upper tolerance                                    |
| Tol A <sub>5</sub> | - 0,02 mm  | Lower tolerance                                    |
| L <sub>4</sub>     | 40 mm      |  |
| L <sub>5</sub>     | 56 mm      | Length of Shaft Support Block without drive System |
| J L <sub>4</sub>   | 28 mm      | Distance   |
| H <sub>2</sub>     | 45 mm      | Center height                                      |
| Tol H <sub>2</sub> | + 0,015 mm | Upper tolerance                                    |
| Tol H <sub>2</sub> | - 0,015 mm | Lower tolerance                                    |
| A <sub>3</sub>     | 30 mm      |  |
| H <sub>6</sub>     | 12 mm      |  |
| N <sub>1</sub>     | 9 mm       |  |
| N <sub>3</sub>     | 15 mm      |  |
| K <sub>5</sub>     | M8         |  |
| K <sub>8</sub>     | NIPA2      | Lubrication nipple                                 |
|                    | 6          | Ball rows  |